

<div>SIRUBA</div> <div>PARTS LIST</div>	Series	Parts Group	Subclass / Remark	Page
	U007	ST-600W-01	# For Pneumatic Automatic % For Electric Automatic	1/6
				Date
				2024/9/06

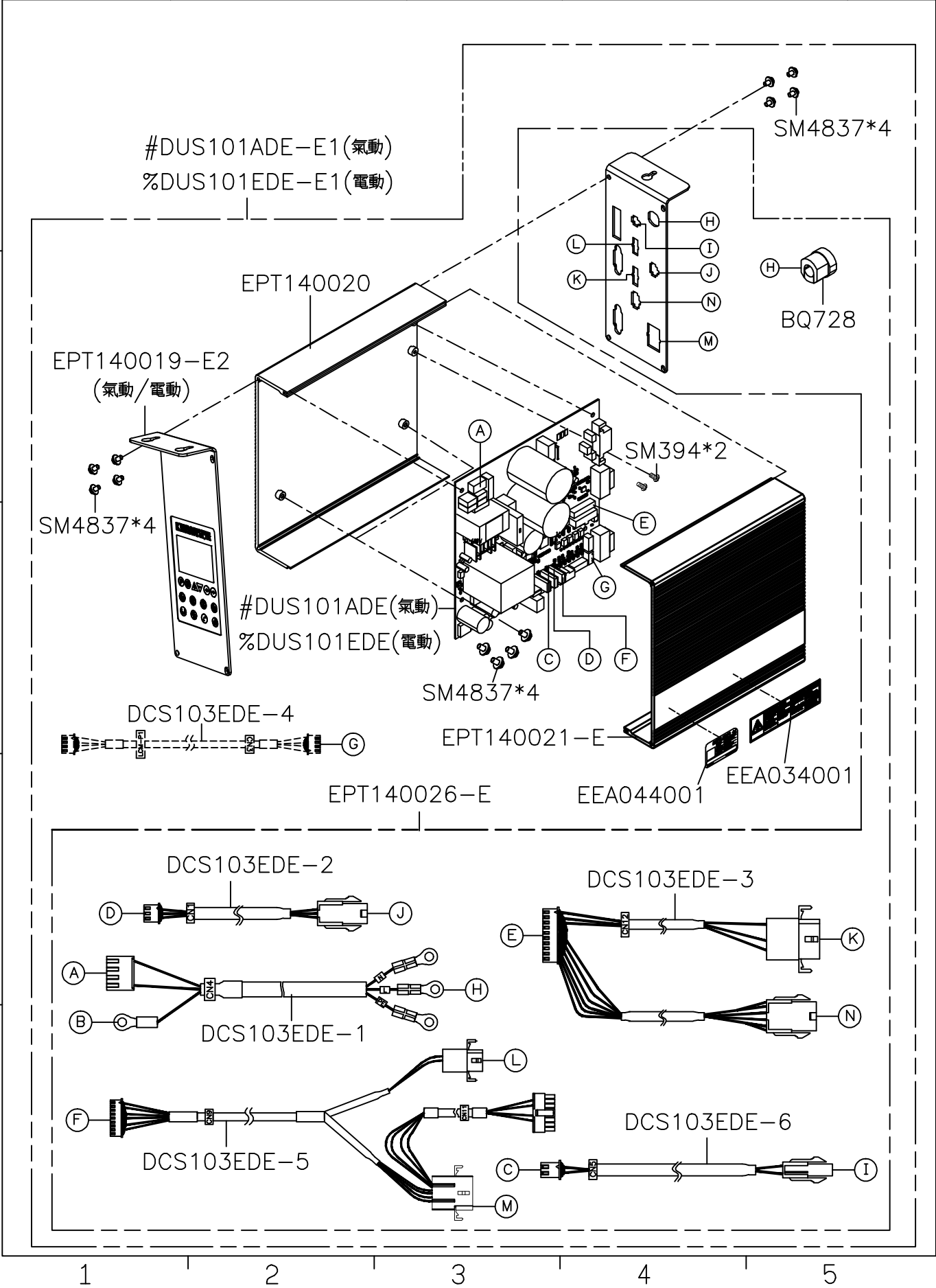

<div>SIRUBA</div> <div>PARTS LIST</div>	Series	Parts Group	Subclass / Remark	Page
	U007	ST-600W-01	-	2/6
				Date
				2024/09/08

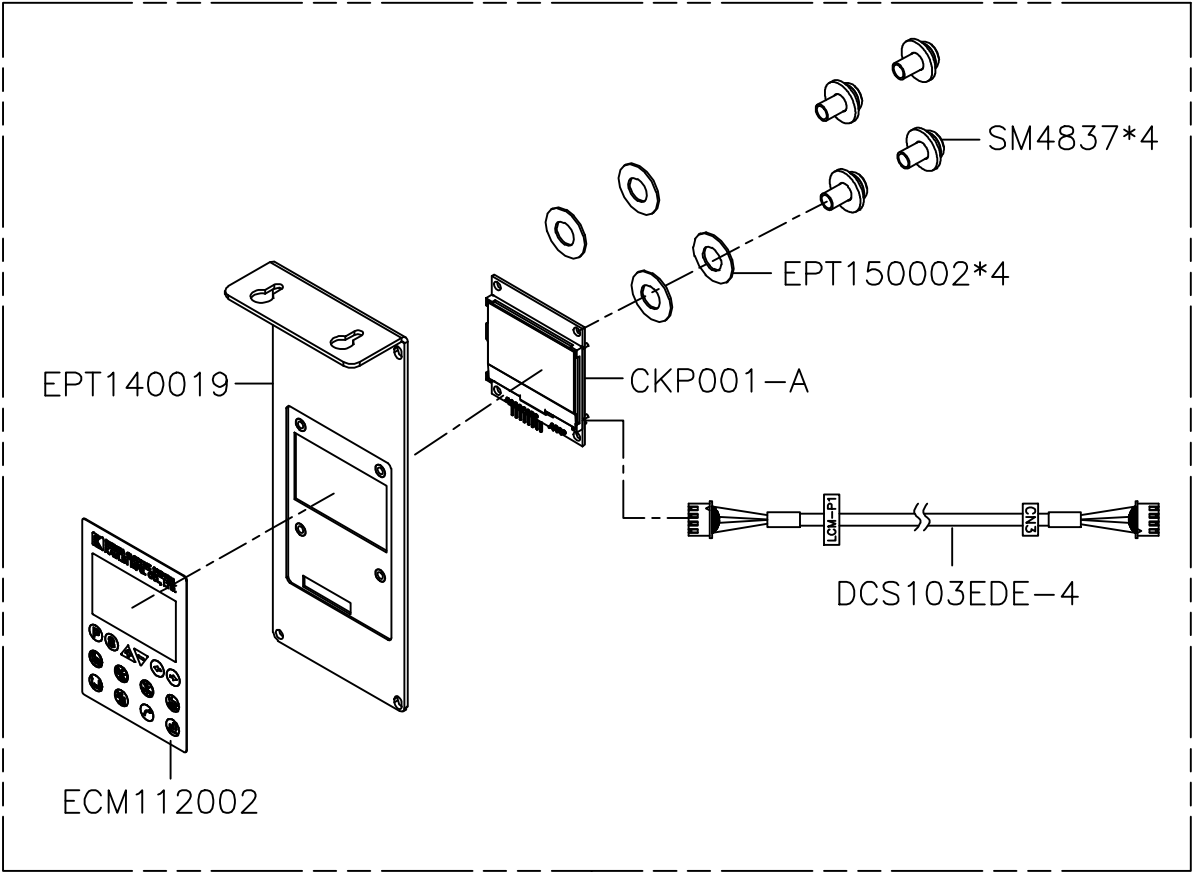

EPT140019-E2

SIRUBA PARTS LIST	Series	Parts Group	Subclass / Remark	Page
	U007	ST-600W-01	-	3/6
				Date
				2024/09/08

A

B

C

D

E

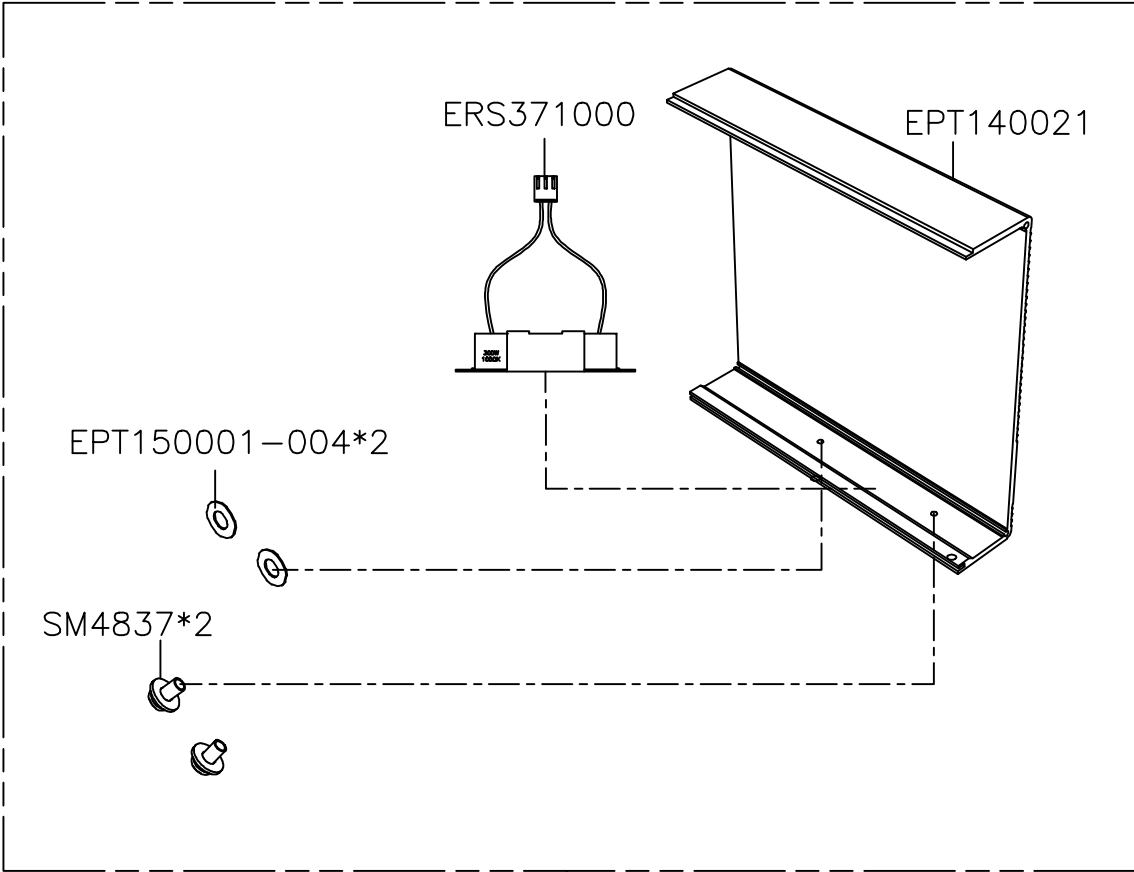

EPT140021-E

1

2

3

4

5

SIRUBA PARTS LIST	Series	Parts Group	Subclass / Remark	Page
	U007	ST-600W-01	-	4/6
				Date
				2024/9/06

A

B

C

D

E

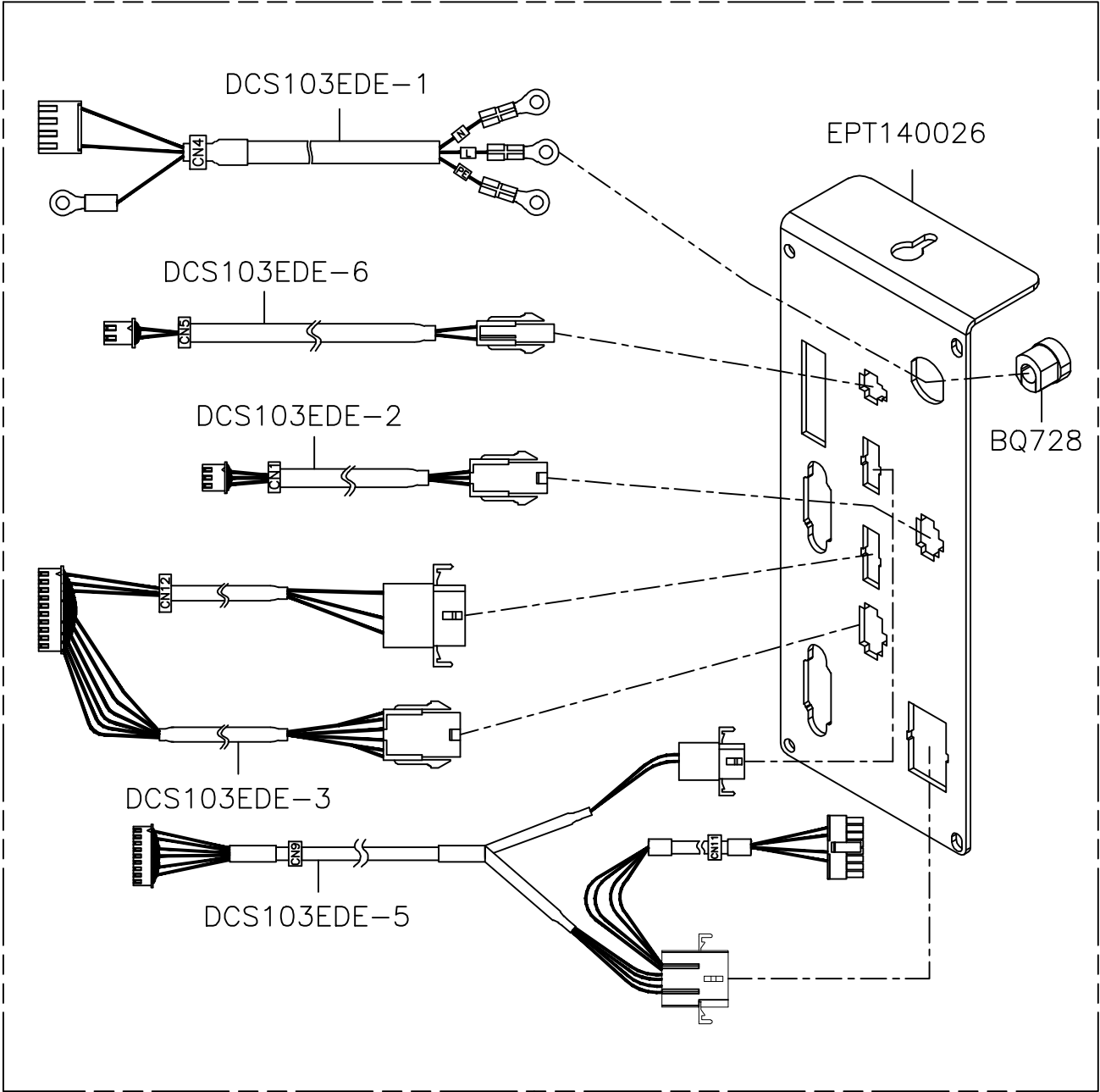

1

2

3

4

5

<div>SIRUBA</div> <div>PARTS LIST</div>	Series	Parts Group	Subclass / Remark	Page
	U007	ST-600W-01	# For Pneumatic Automatic % For Electric Automatic	5/6
				Date
				2024/9/06

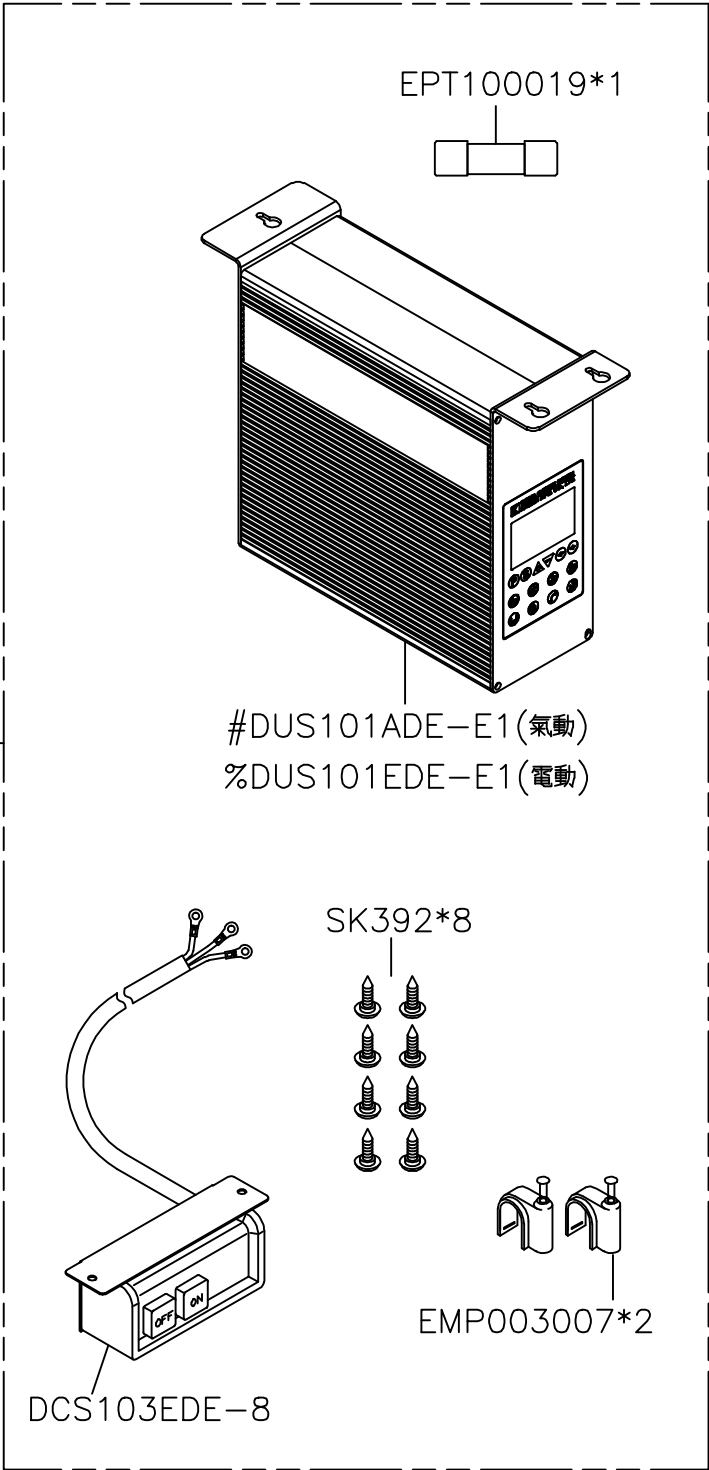

#DUS101ADE-A2(氣動)
%DUS101EDE-A2(電動)

<div> <div>SIRUBA</div> <div>PARTS LIST</div> </div>	Series	Parts Group	Subclass / Remark	Page
	U007	ST-600W-01	# For Pneumatic Automatic % For Electric Automatic	6/6
				Date
				2024/09/08

EPT100019*1



EMP003007*2



SK392*8

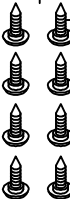

DCS103EDE-8

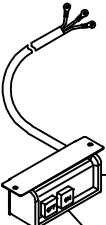

KZ03

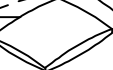

C21177

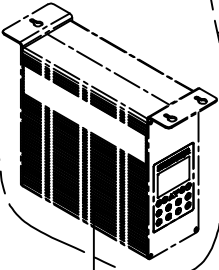

#DUS101ADE-E1(氣動)
%DUS101EDE-E1(電動)

EPT160003

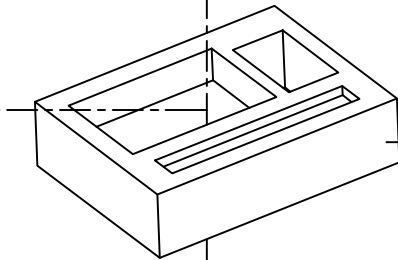

EPT160002*2

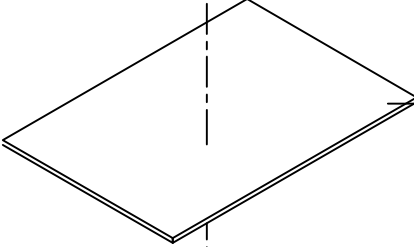

EPT160004

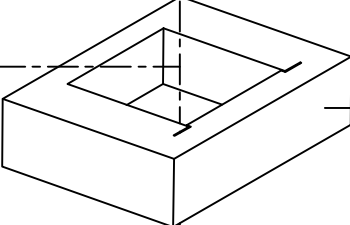

EPT160001

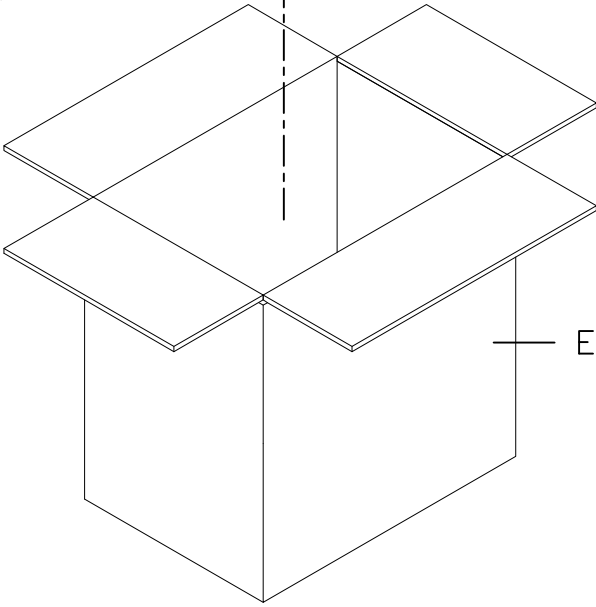

SIRUBA PARTS LIST	Series	Parts Group	Subclass / Remark	Page
	U007	UTT(UTU)-K		1/9
				Date
				2022/11/24

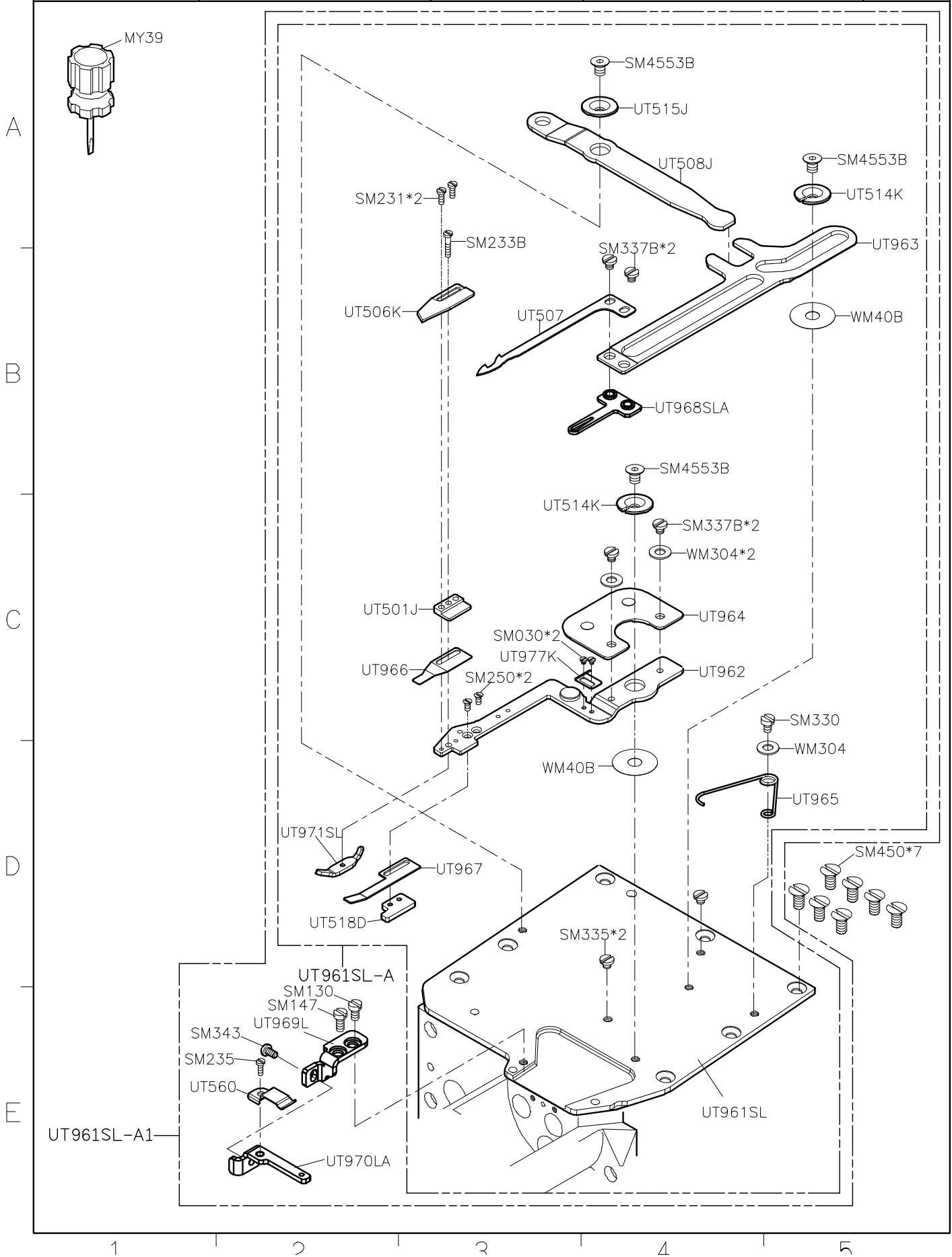

SIRUBA

PARTS LIST

Series

S007K
S007KD
U007

Parts Group

UTT-K
UTU-K

Subclass / Remark

For S007K/S007KD 2nd Generation
□:  Use for H brand motor
Δ: Use for SCR

Page

Date _____

2025/4/23

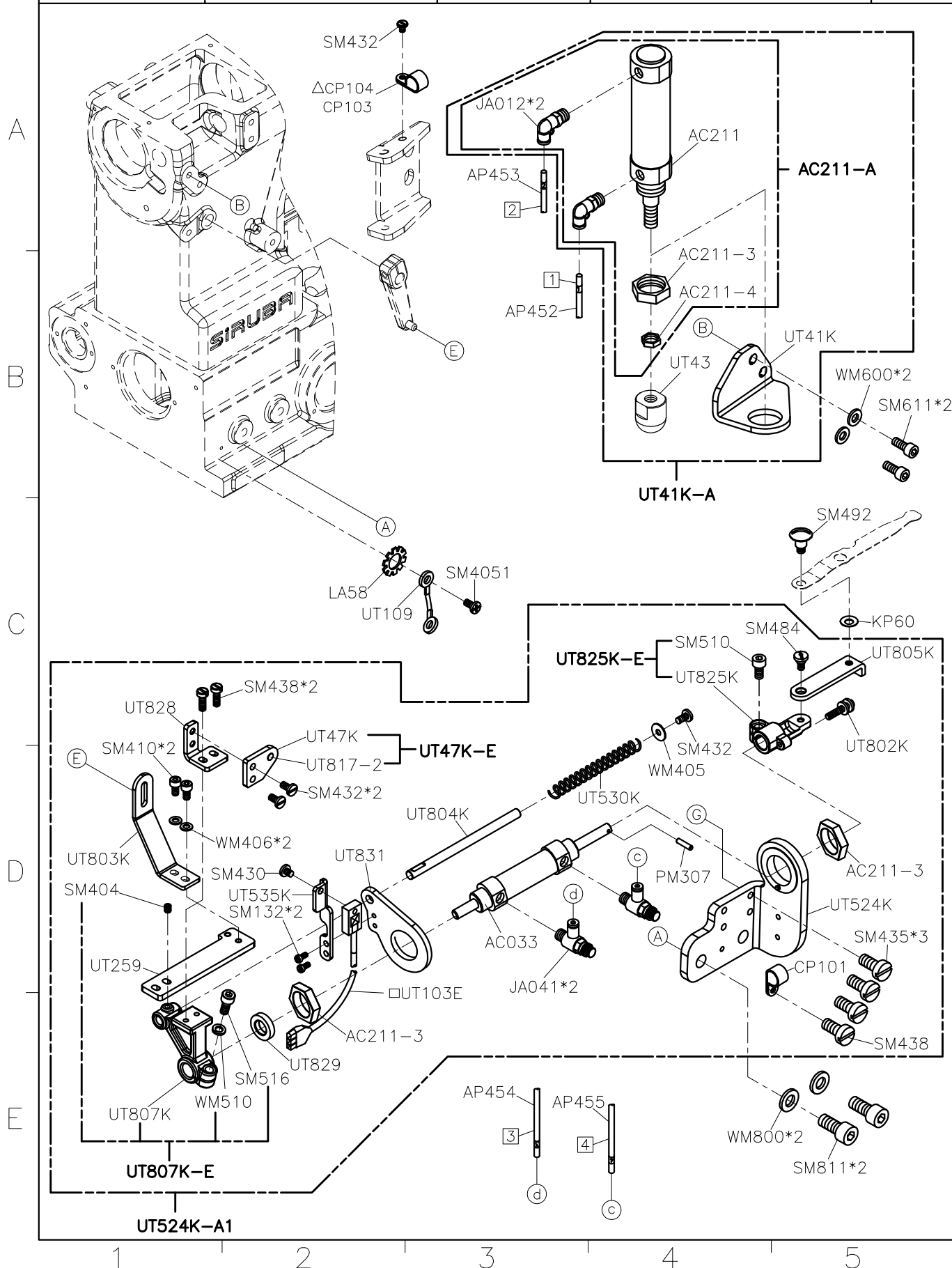

SIRUBA PARTS LIST	Series	Parts Group	Subclass / Remark	Page
	S007K/S007KD U007	UTT(UTU)-K	For S007K/S007KD 2 nd Generation ☐ : Use for H brand motor	3/9
				Date
				2016/8/24

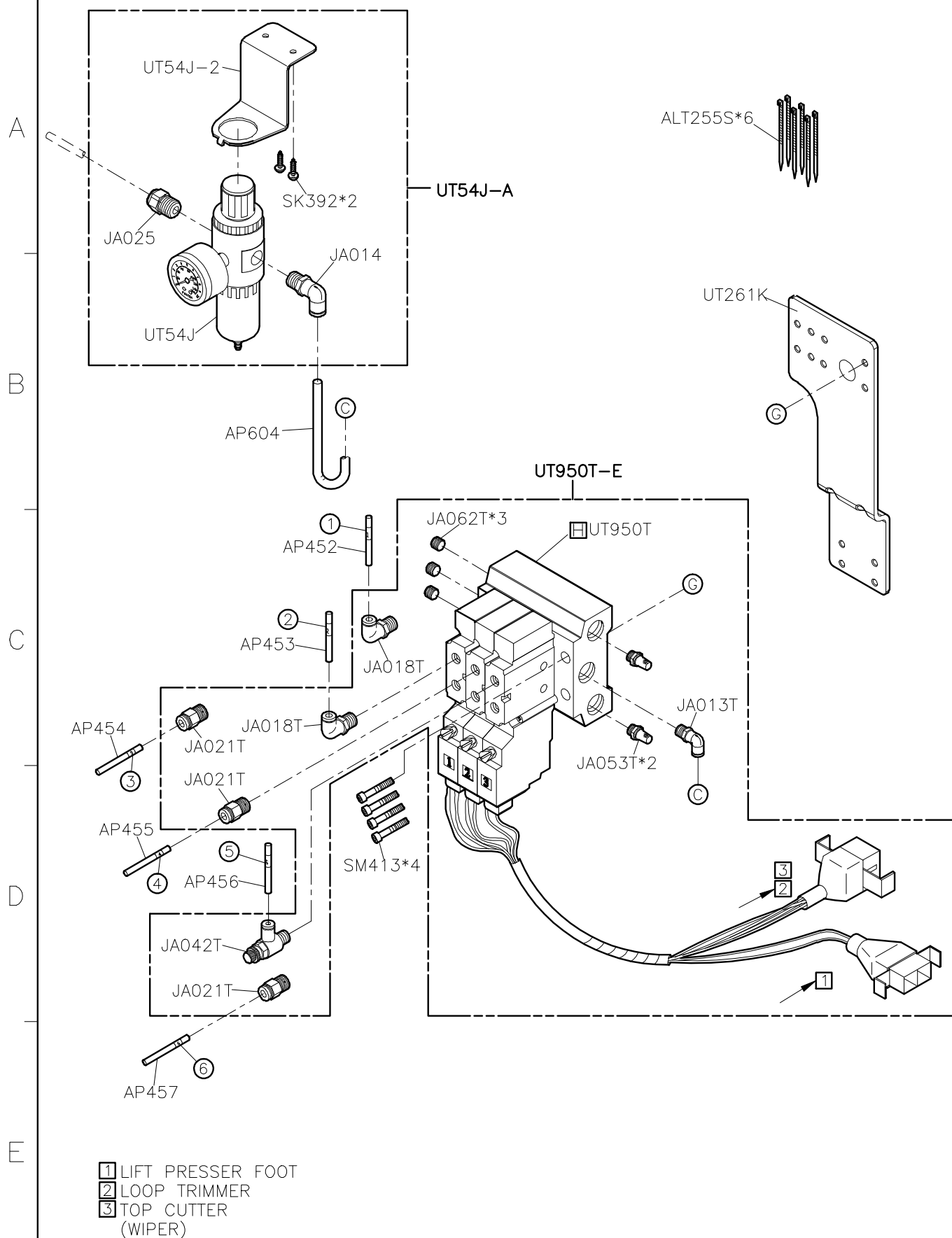

SIRUBA PARTS LIST	Series	Parts Group	Subclass / Remark	Page
	S007K/S007KD U007	UTT(UTU)-K	For S007K/S007KD 2nd Generation	4/9
				Date
				2016/8/24

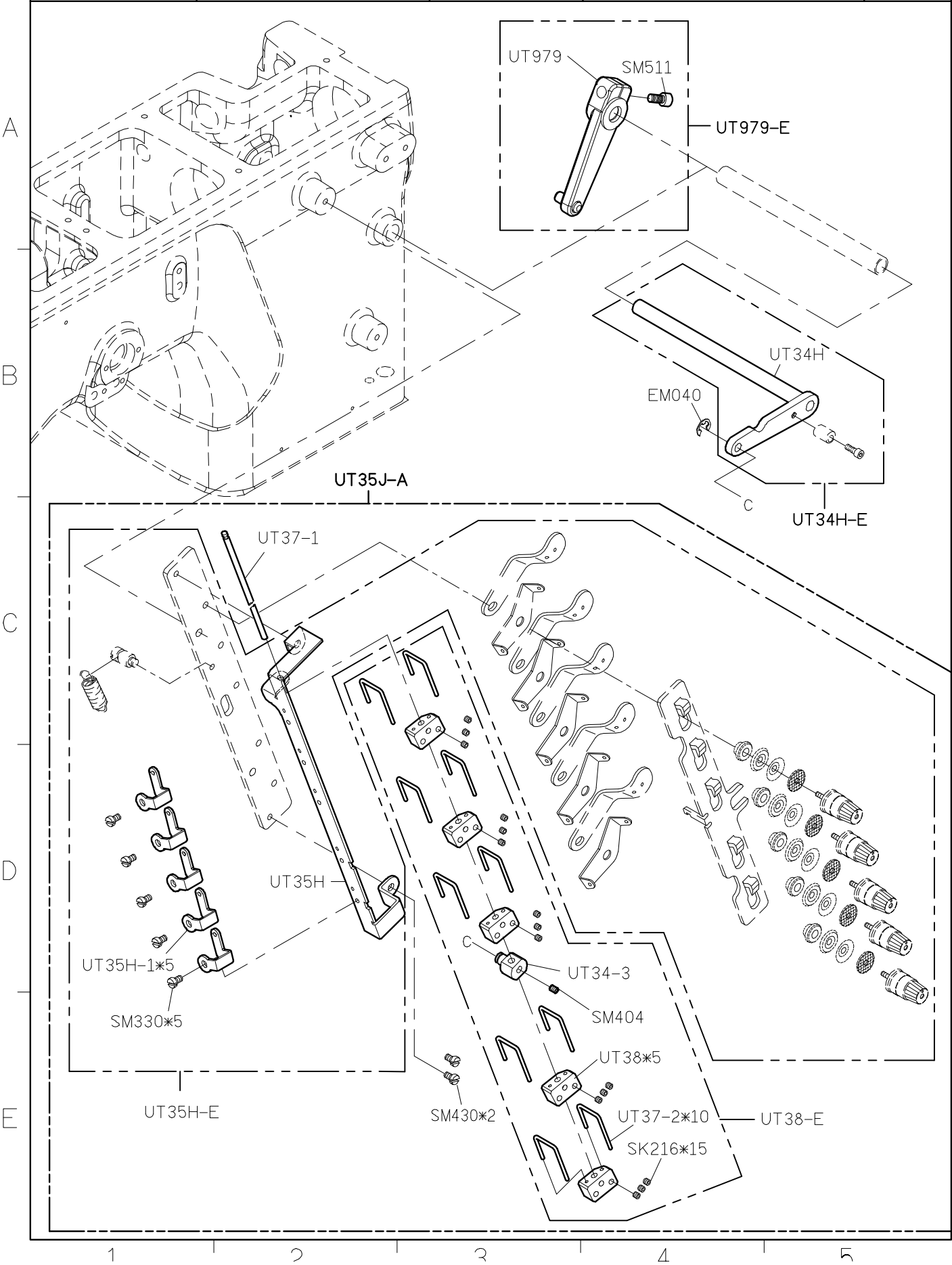

SIRUBA PARTS LIST	Series	Parts Group	Subclass / Remark	Page
	S007K/S007KD U007	UTU-K	For S007K/S007KD 2 nd Generation	5/9
				Date
				2022/09/27

FOR LEFT SIDE

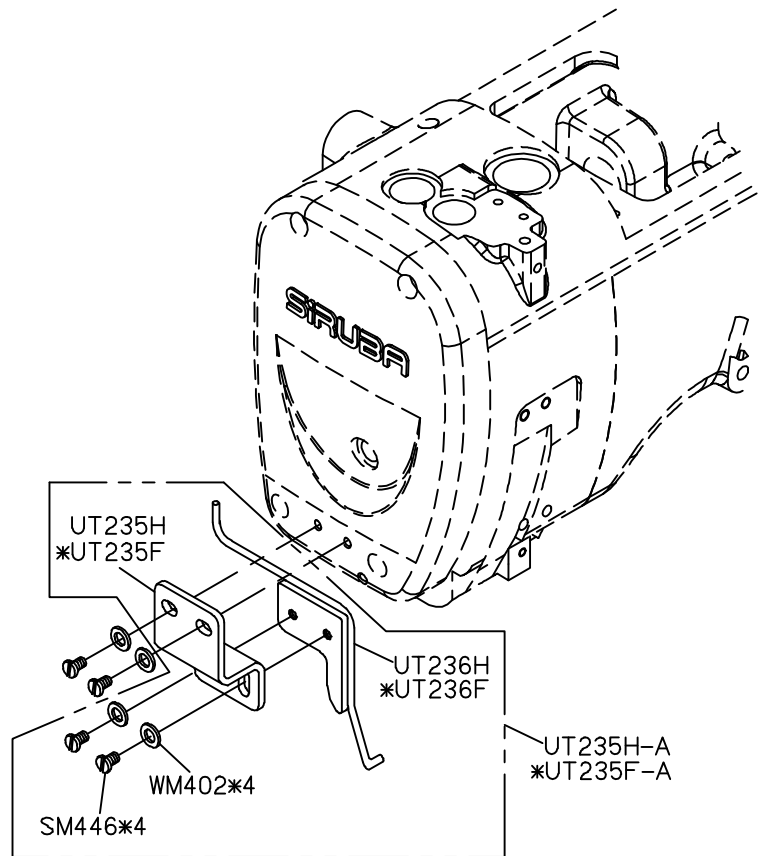

SIRUBA PARTS LIST	Series	Parts Group	Subclass / Remark	Page
	S007K/S007KD U007	UTU-K1	For allocation	6/9
				Date
				2020/4/17

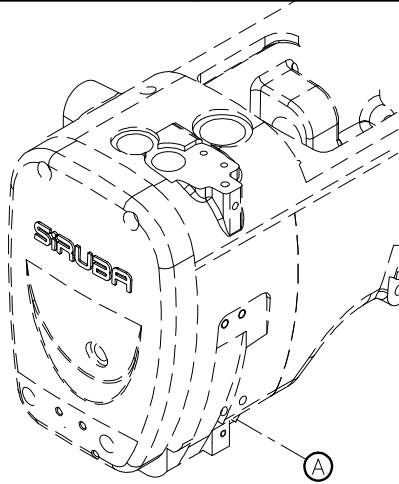

WP51L-A1

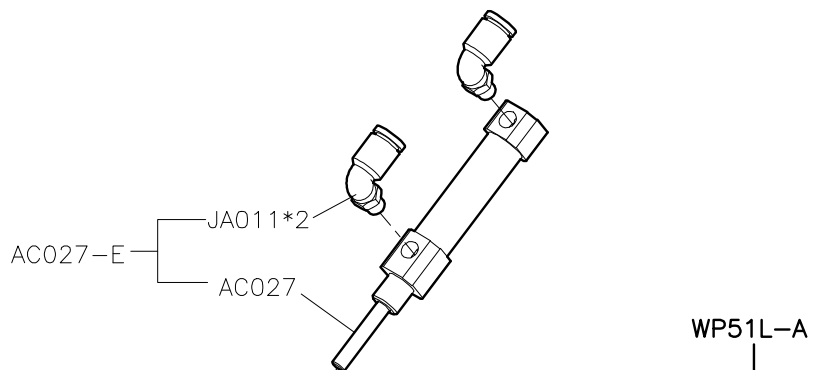

WP51L-A

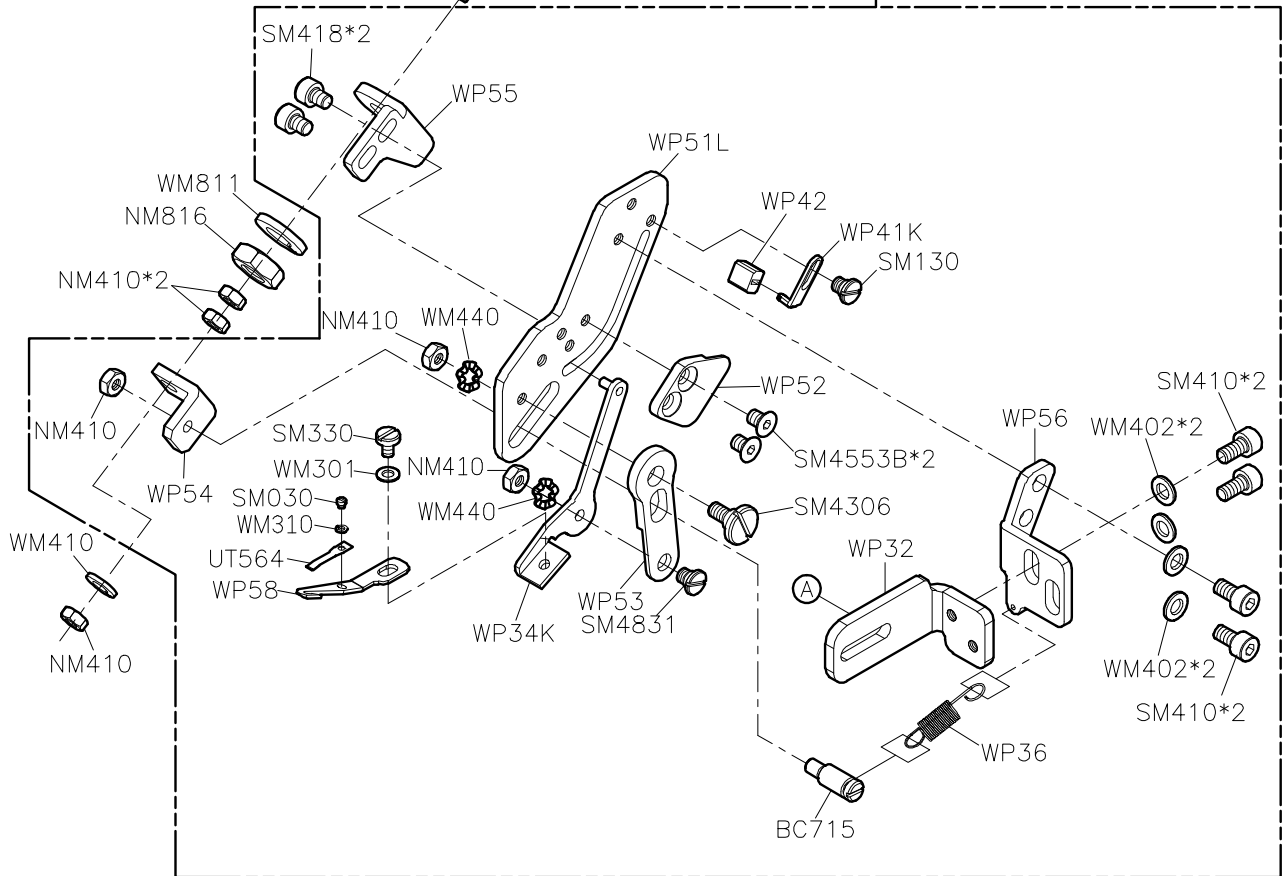

1

2

3

4

5

SIRUBA PARTS LIST	Series	Parts Group	Subclass / Remark	Page
	S007K S007KD U007	UTT-K	For S007K/S007KD 2 nd Generation Δ: Use for SCR	7/9
				Date
				2025/4/23

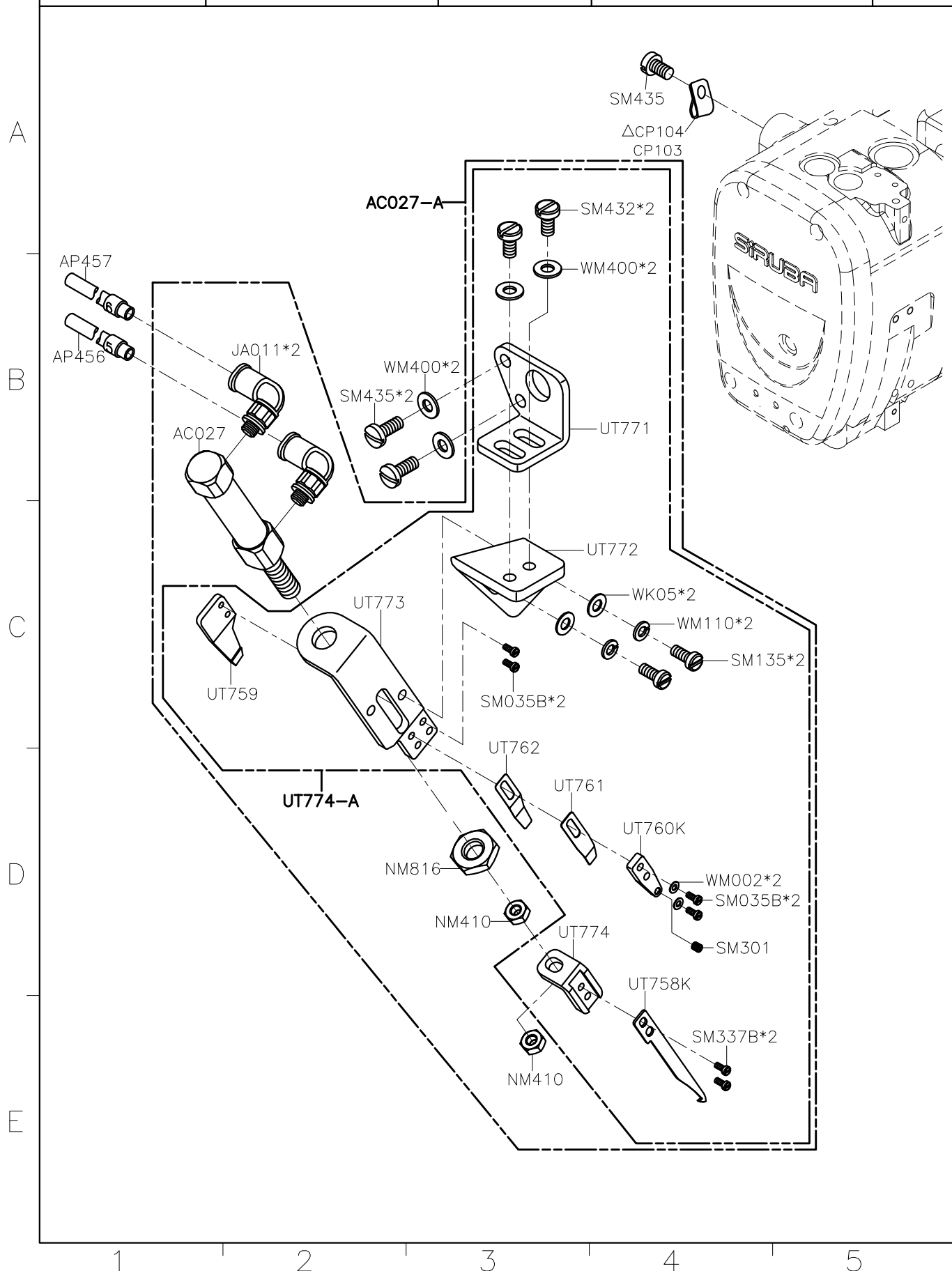

SIRUBA PARTS LIST	Series	Parts Group	Subclass / Remark	Page
	S007K/S007KD U007	UTT(UTU)-K	For S007K/S007KD 2 nd Generation ☐ : Use for H brand motor	8/9
				Date
				2016/9/14

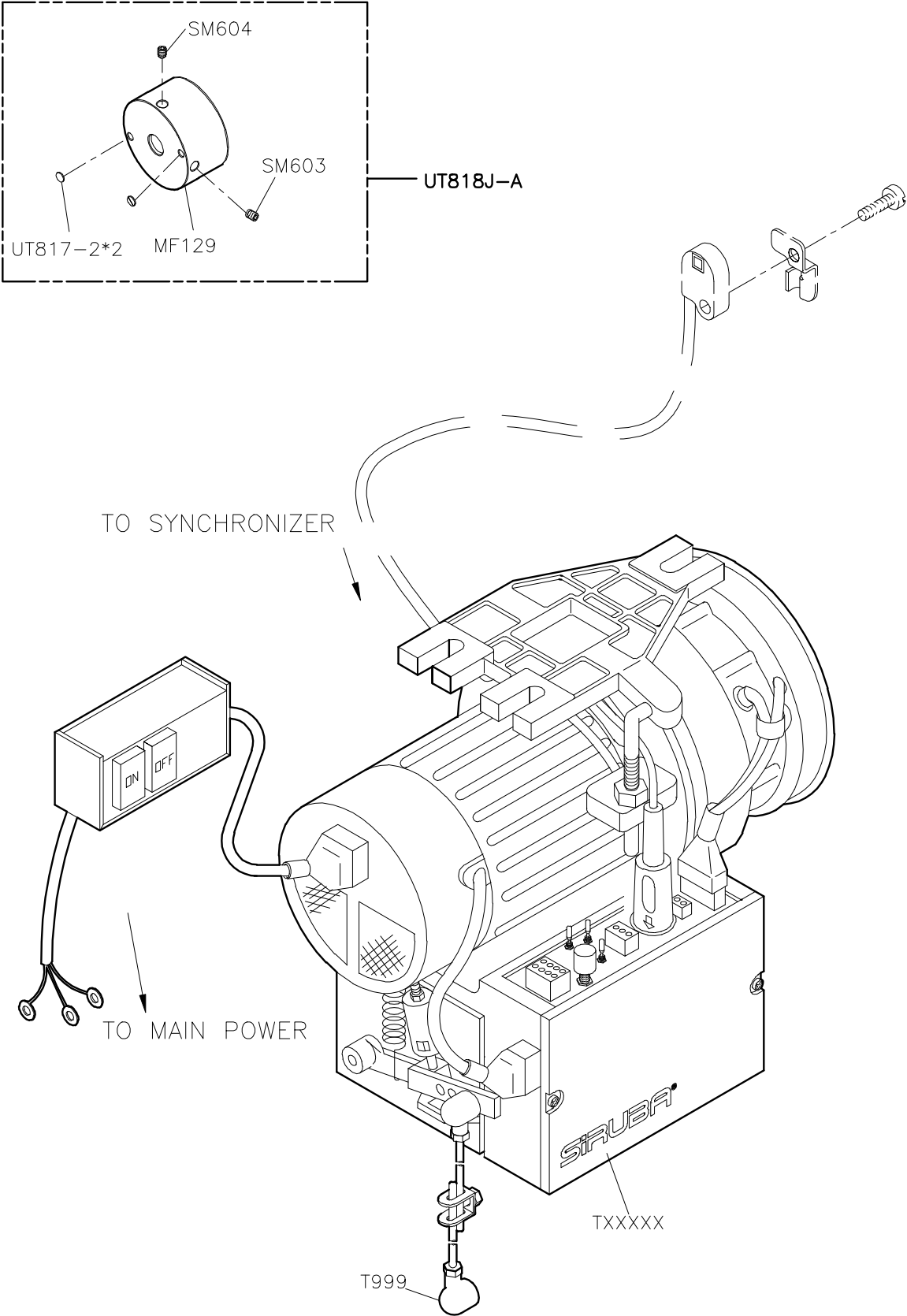

SIRUBA PARTS LIST	Series	Parts Group	Subclass / Remark	Page
	S007K/S007KD U007	UTT(UTU)-K	For S007K/S007KD 2 nd Generation ☐ : Use for H brand motor (i - 60)	9/9
				Date
				2016/8/24

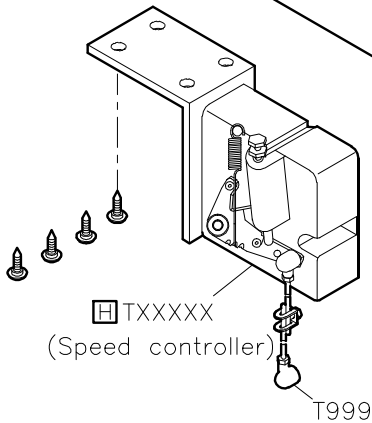
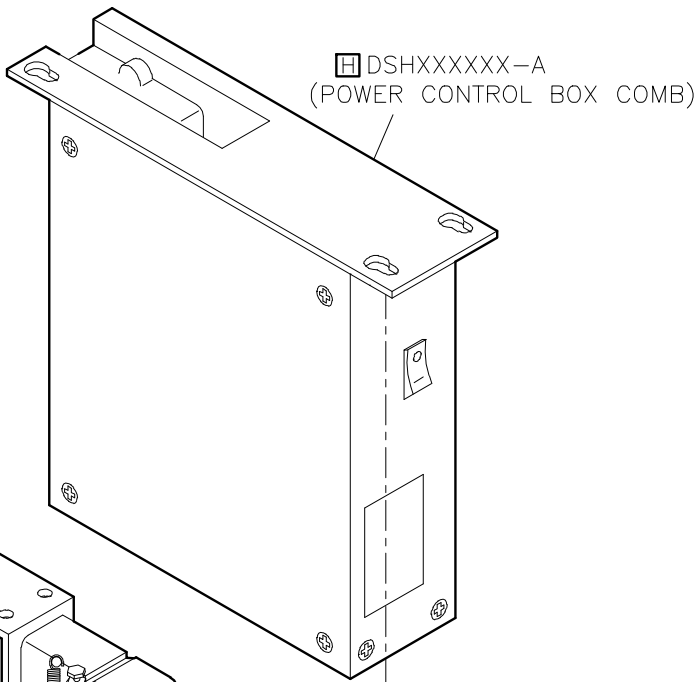
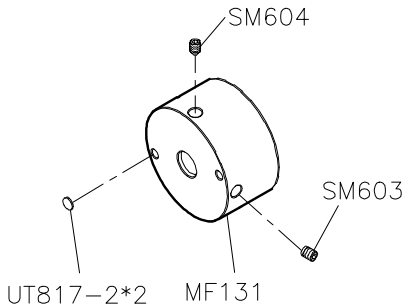

SIRUBA

PARTS LIST

Series

U007

Parts Group

UTX(UTY)-K

Subclass / Remark

Page

1/9

Date

2020/7/15

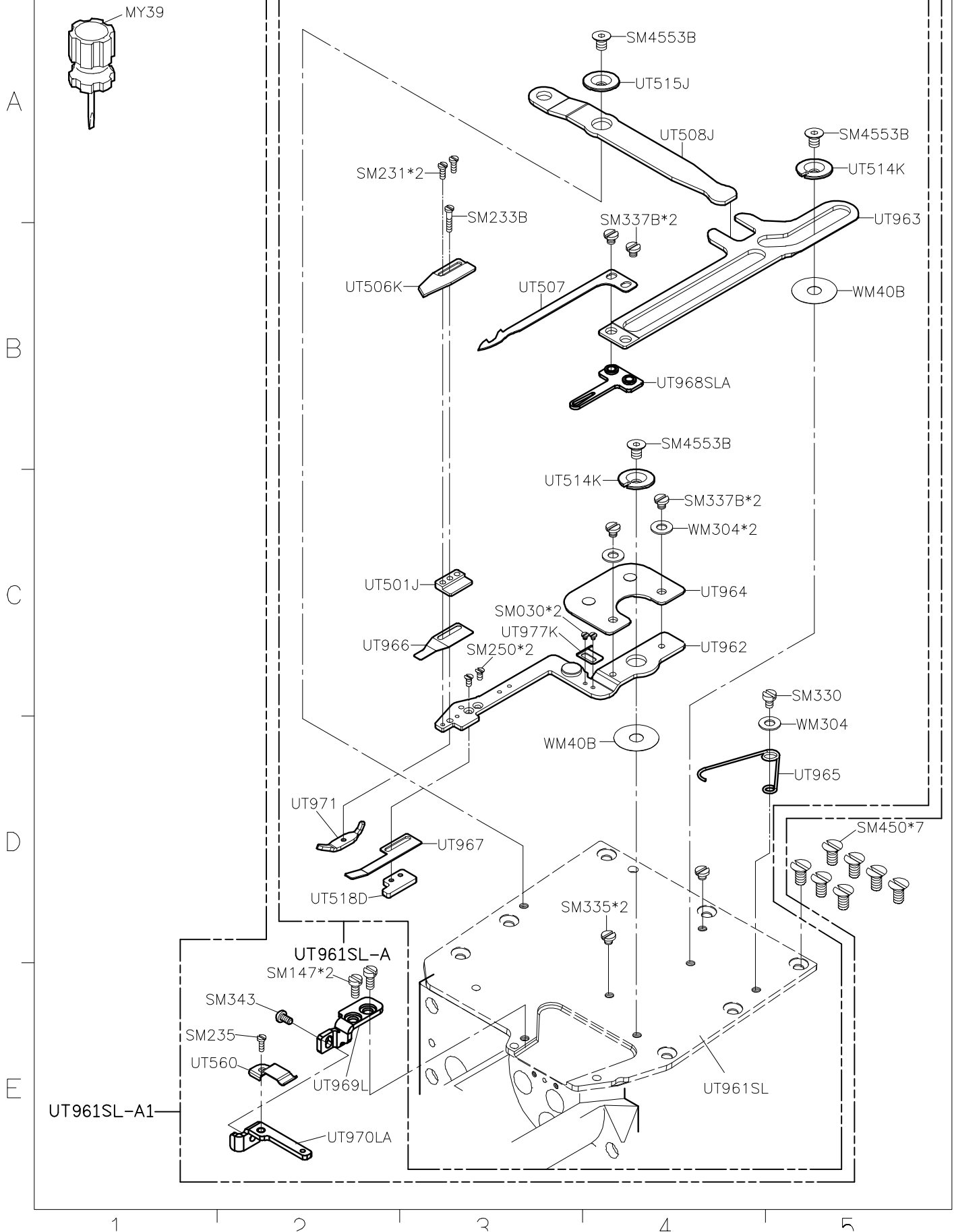

SIRUBA
PARTS LIST

Series
**S007K/S007KD
U007**

Parts Group
UTX(UTY)-K

Subclass / Remark
For S007K/S007KD 2nd Generation
☐ : Use for H brand motor

Page
2/9
Date
2016/8/23

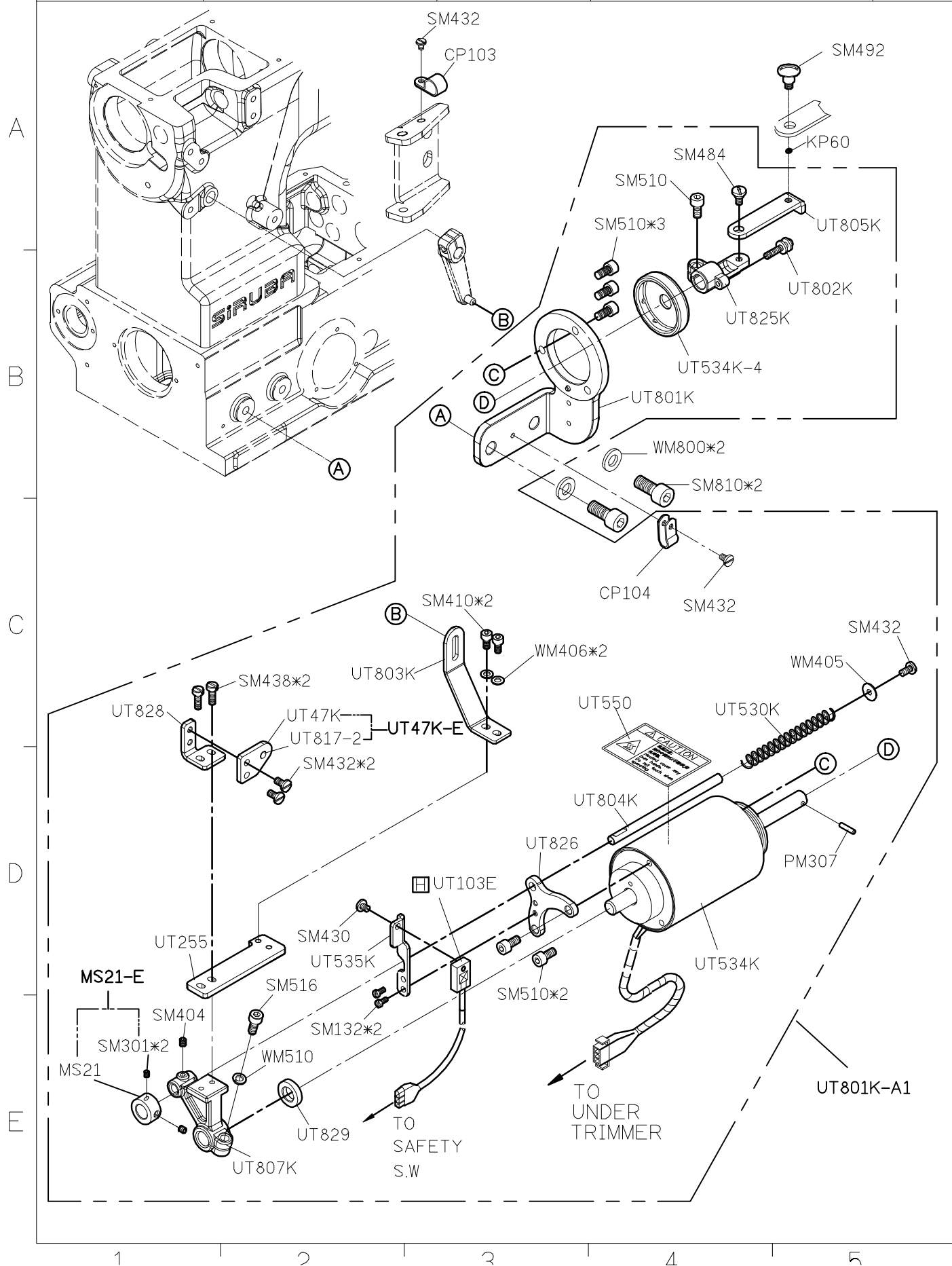

SIRUBA PARTS LIST	Series	Parts Group	Subclass / Remark	Page
	S007K/S007KD U007	UTX(UTY)-K	For S007K/S007KD 2nd Generation	3/9
				Date
				2020/4/17

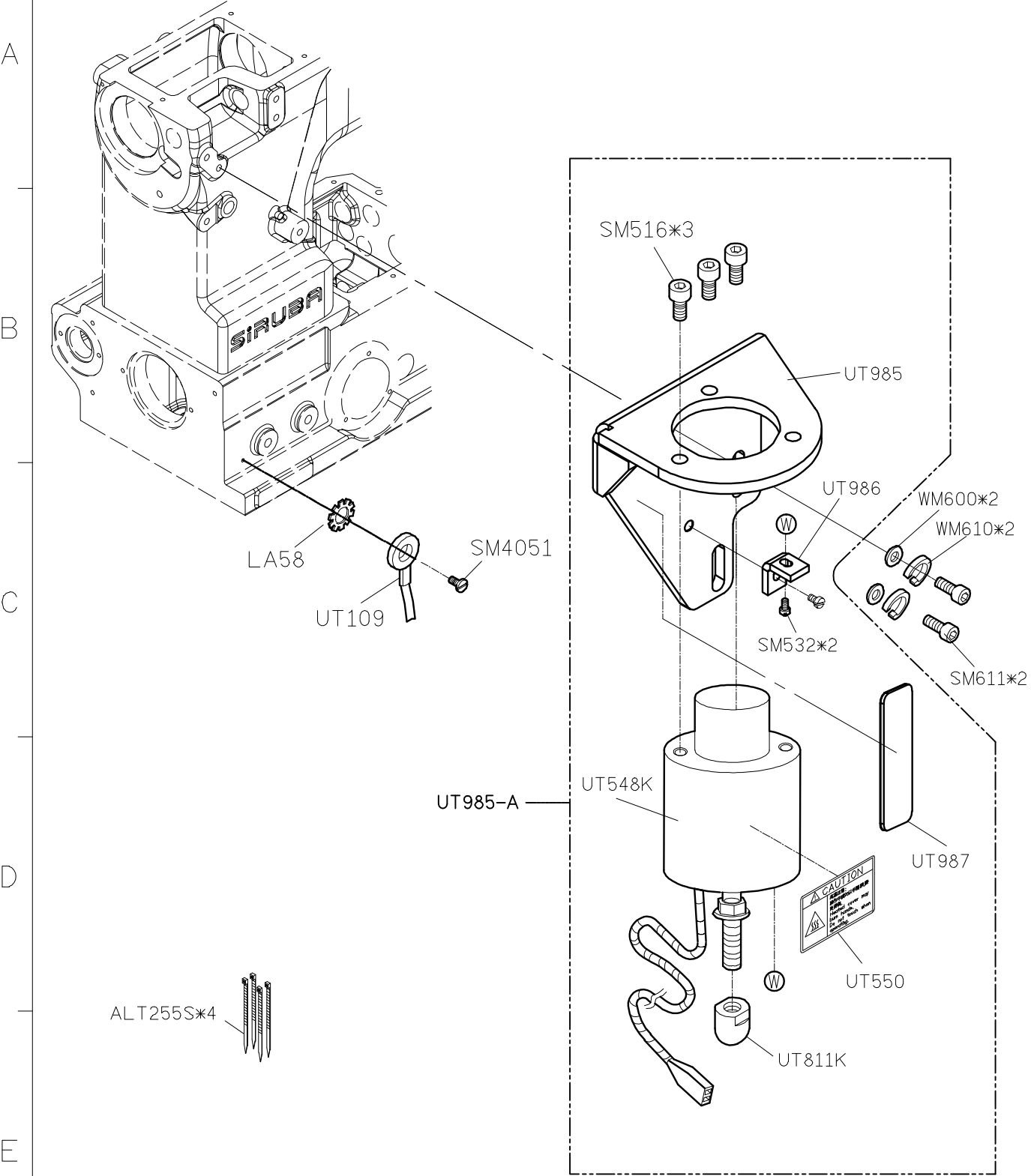

SIRUBA PARTS LIST	Series	Parts Group	Subclass / Remark	Page
	S007K/S007KD U007	UTX(UTY)-K	For S007K/S007KD 2nd Generation	4/9
				Date
				2016/8/23

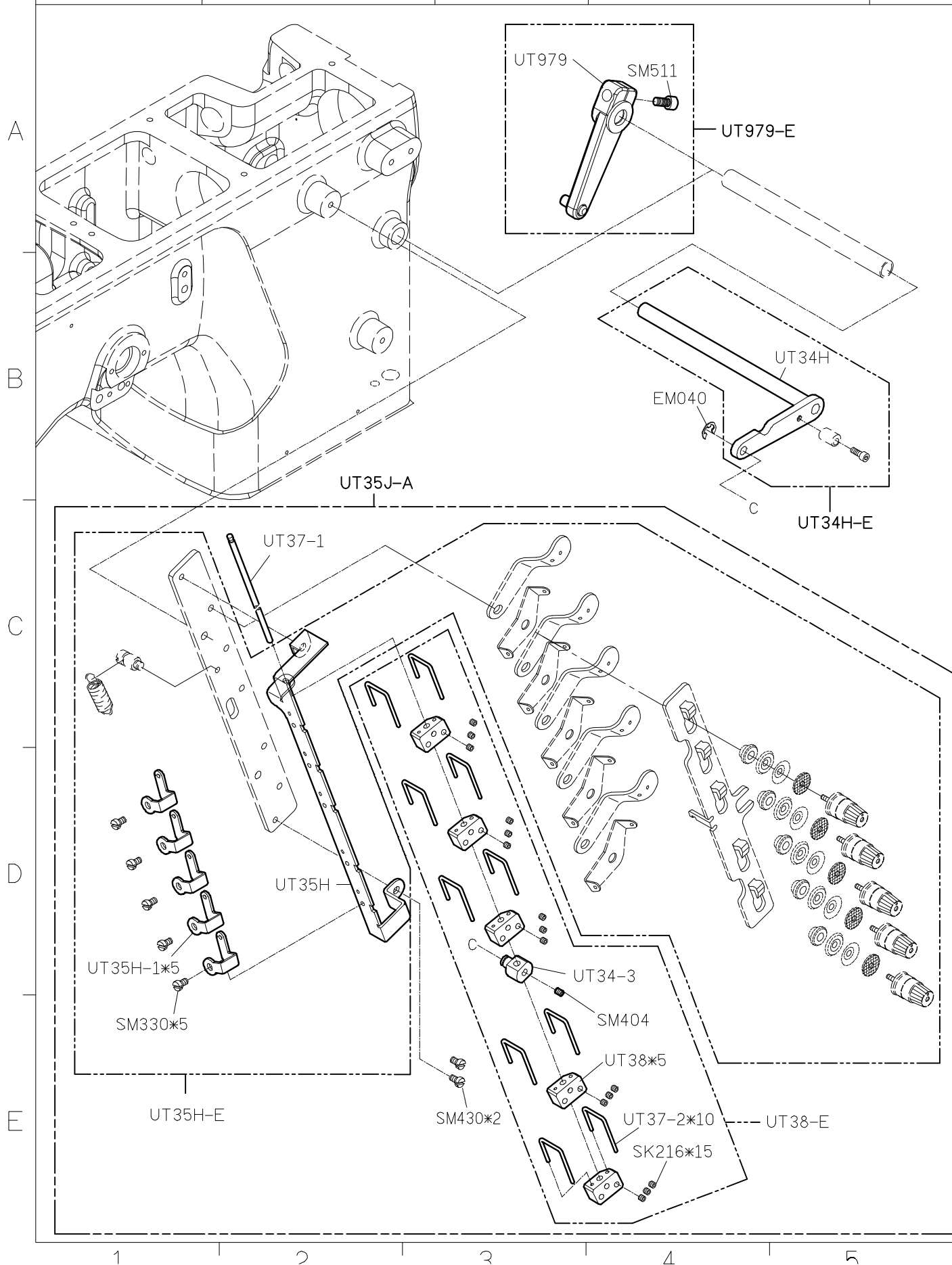

SIRUBA PARTS LIST	Series	Parts Group	Subclass / Remark	Page
	S007K/S007KD U007	UTY-K	For S007K/S007KD 2 nd Generation	6/9
				Date
				2020/4/17

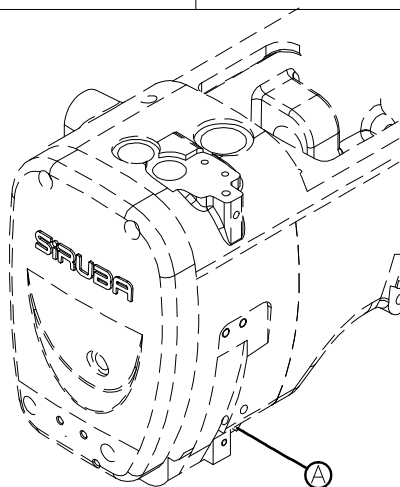

WP54A-A1

UT776A

WP54A-A

SM418*2

WP55A

WP51L

WMA11
NMA10

WM50B
NM517

NM410

WM440

WP52

WP42

WP41K
SM130

SM410*2

WP56

WM402*2

SM330
WM301

NM410
WM440

SM4553B*2

SM4306

WP54A
SM030
WM310

WM510
NM517

UT564
WP58

WP34K

WP53
SM4831

WP32

WP36

BC715

WM402*2

SM410*2

1

2

3

4

5

SIRUBA PARTS LIST	Series	Parts Group	Subclass / Remark	Page
	S007K/S007KD U007	UTX(UTY)-K	For S007K/S007KD 2 nd Generation □ : Use for H brand motor	7/9
				Date
				2016/8/23

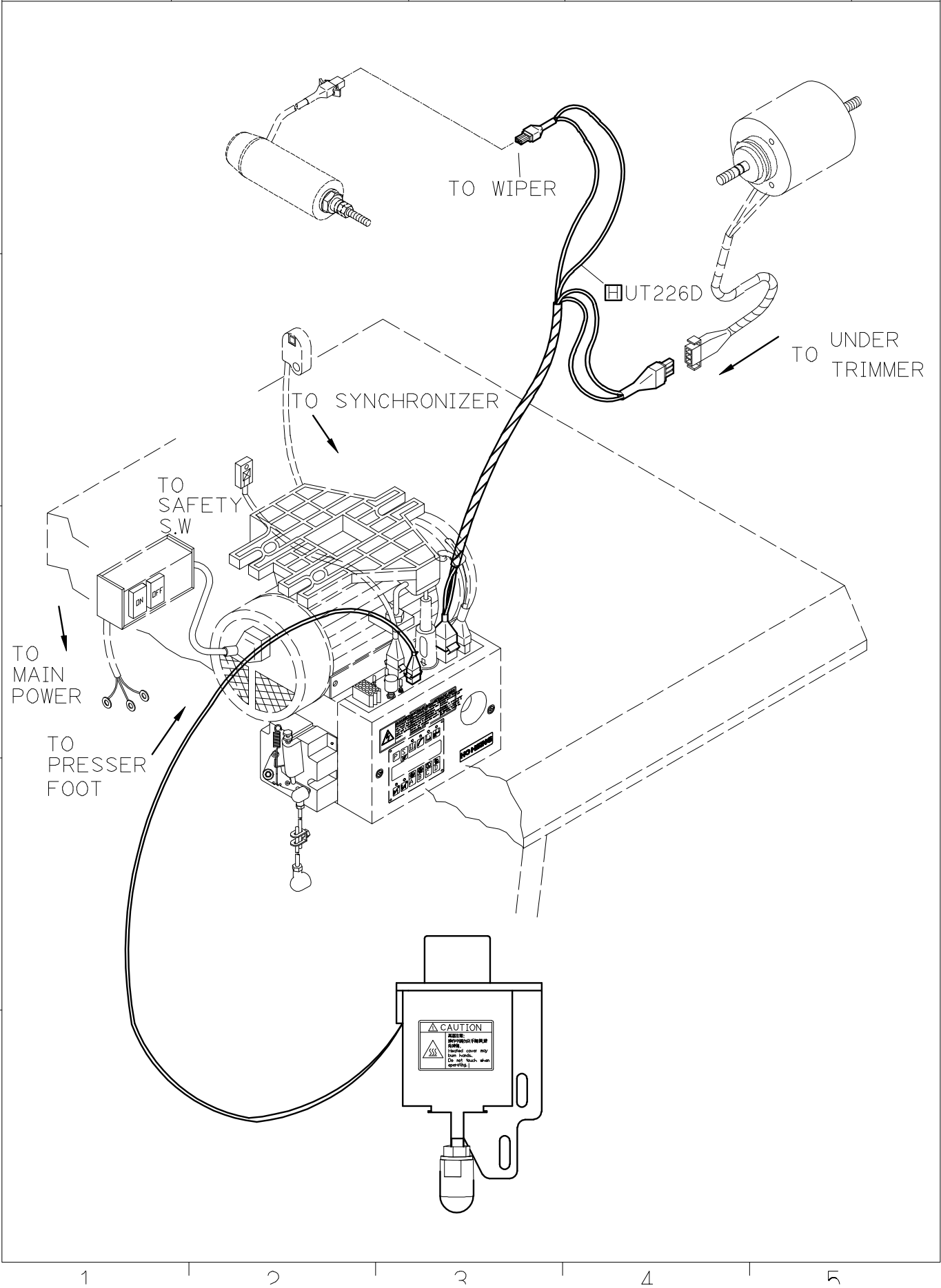

SIRUBA PARTS LIST	Series	Parts Group	Subclass / Remark	Page
	S007K/S007KD U007	UTX(UTY)-K	For S007K/S007KD 2 nd Generation ☐ : Use for H brand motor	8/9
				Date
				2016/8/23

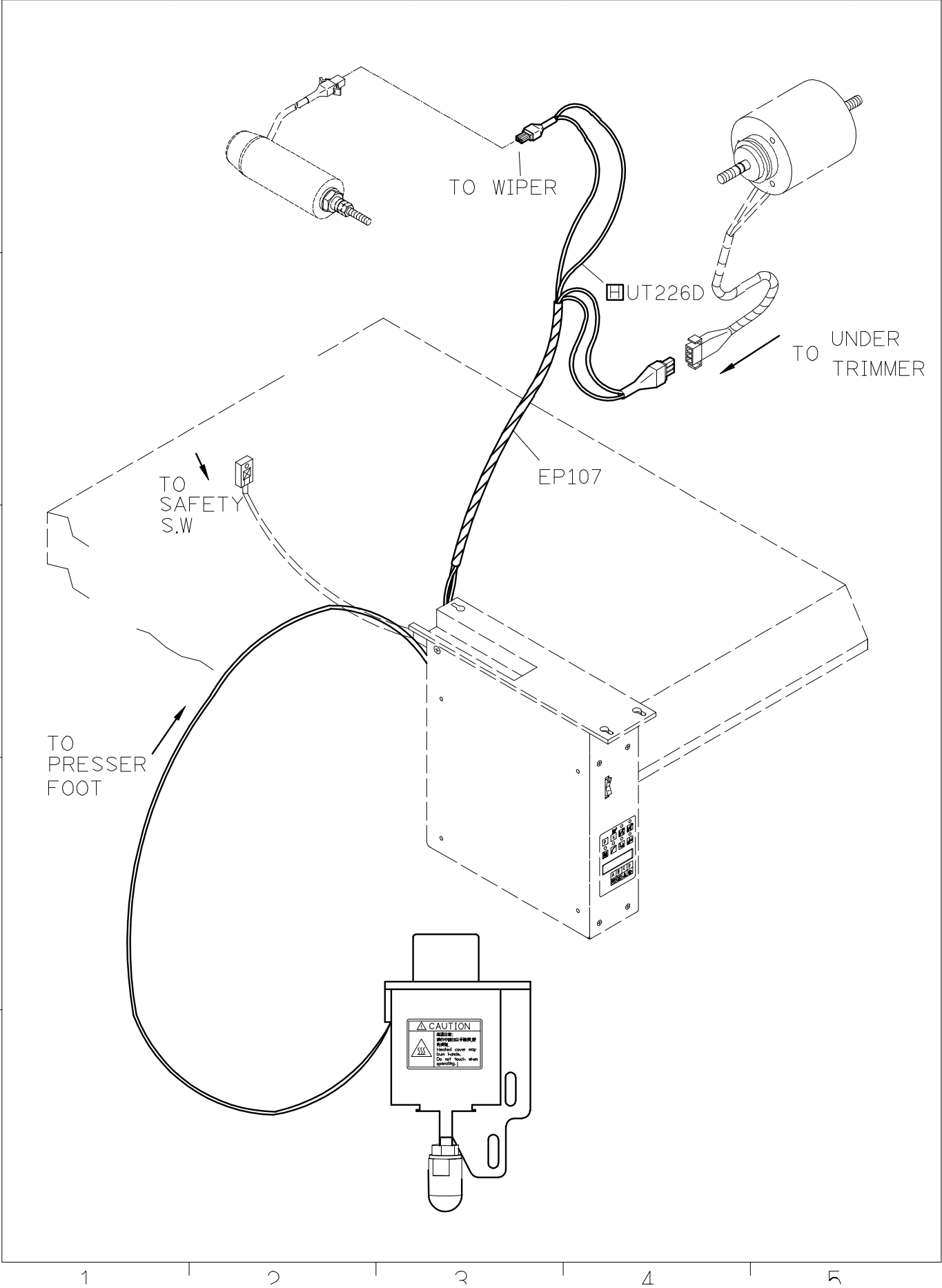

<div> <div>SIRUBA</div> <div>PARTS LIST</div> </div>	Series	Parts Group	Subclass / Remark	Page
	<div> <div>S007K/S007KD</div> <div>U007</div> </div>	<div>UTX(UTY)-K</div>	<div> <div>For S007K/S007KD 2nd Generation</div> <div> <div>☐</div> <div>: Use for H brand motor</div> <div>(1-60)</div> </div> </div>	9/9
				Date
				2016/8/23

