

SIRUBA PARTS LIST	Series	Parts Group	Subclass / Remark	Page
	U007	UTT(UTU)-K		1/9
				Date
				2022/11/24

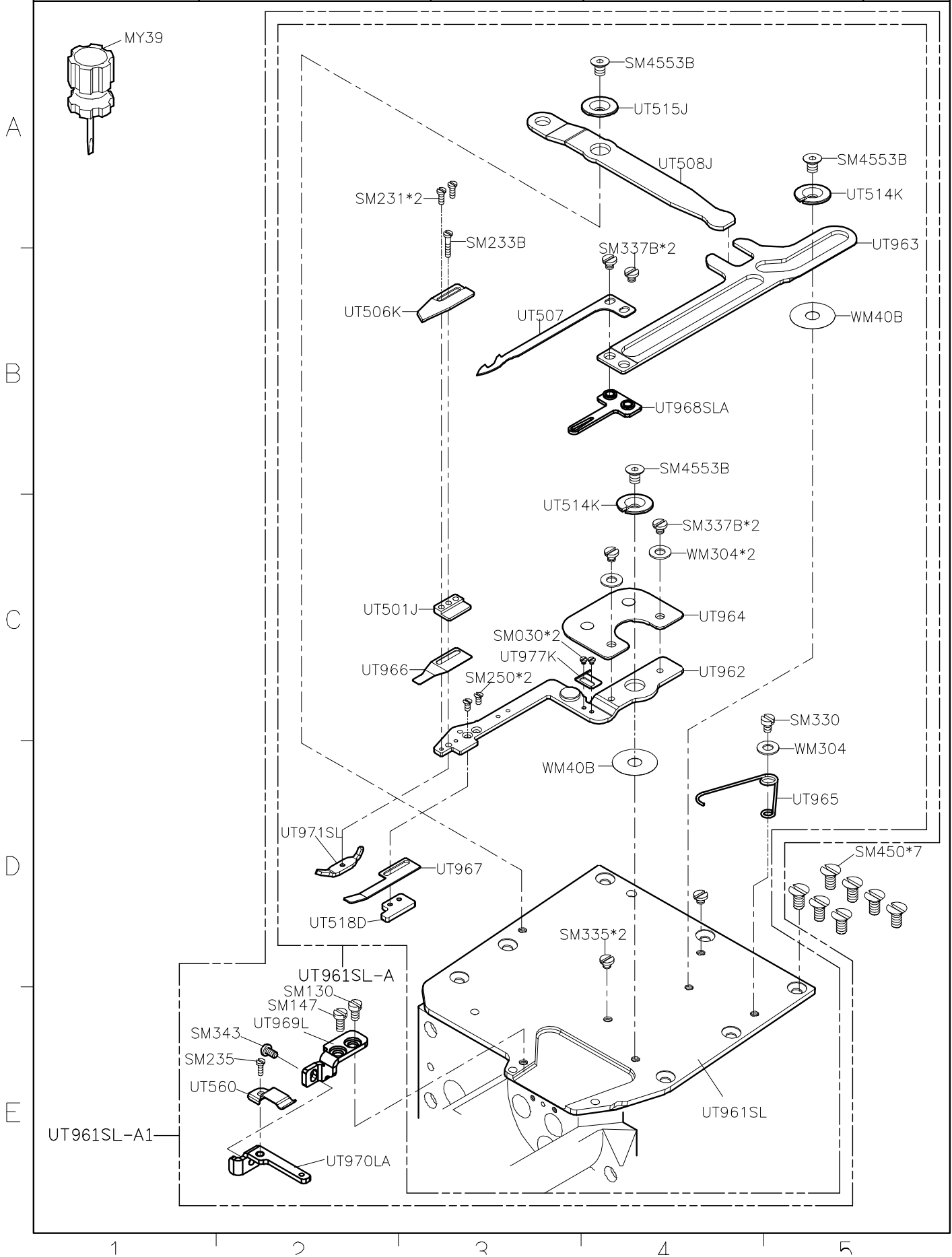

SIRUBA PARTS LIST	Series	Parts Group	Subclass / Remark	Page
	S007K/S007KD U007	UTT(UTU)-K	For S007K/S007KD 2 nd Generation [H] : Use for H brand motor	2/9
				Date
				2020/4/17

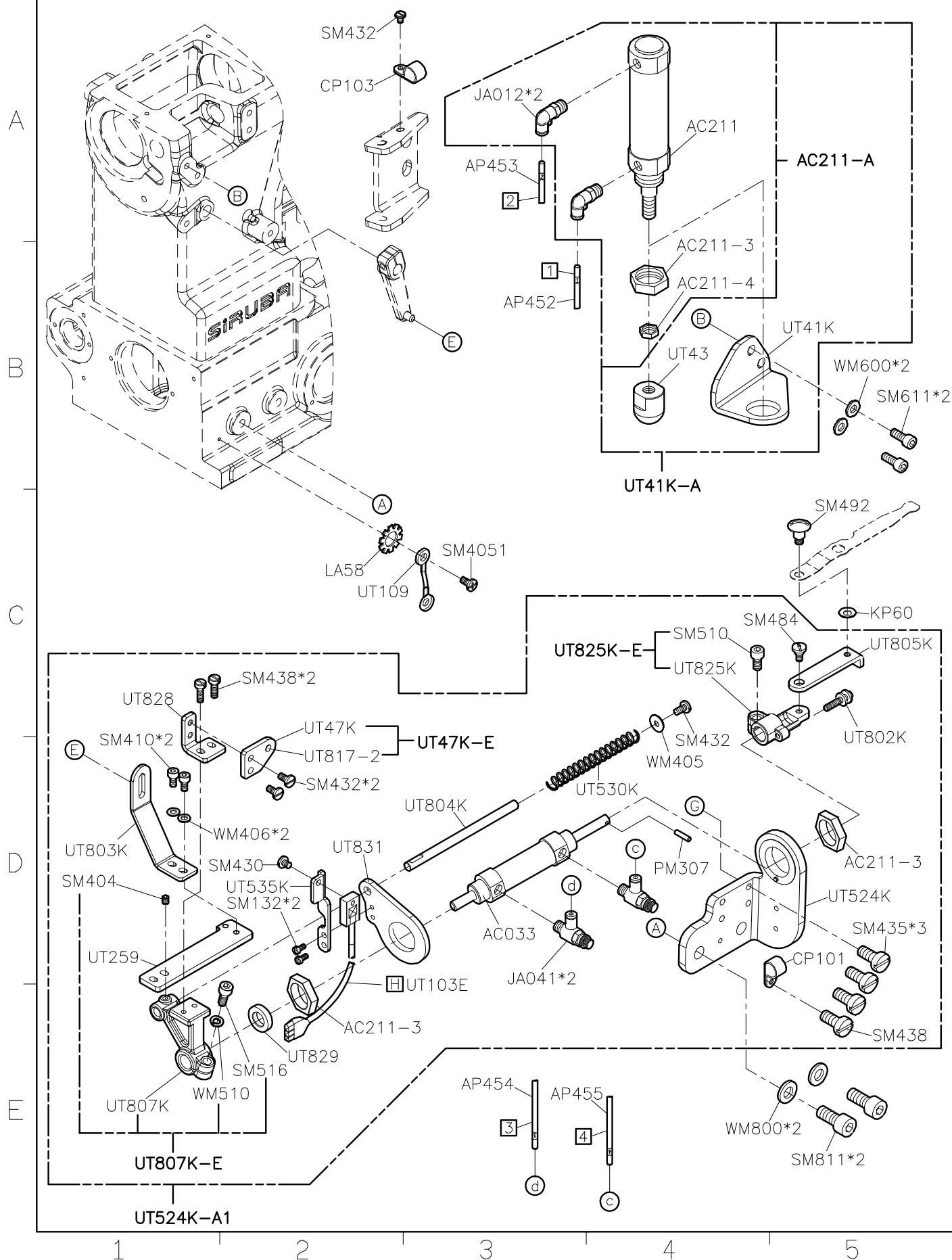

SIRUBA PARTS LIST	Series	Parts Group	Subclass / Remark	Page
	S007K/S007KD U007	UTT(UTU)-K	For S007K/S007KD 2 nd Generation ☐ : Use for H brand motor	3/9
				Date
				2016/8/24

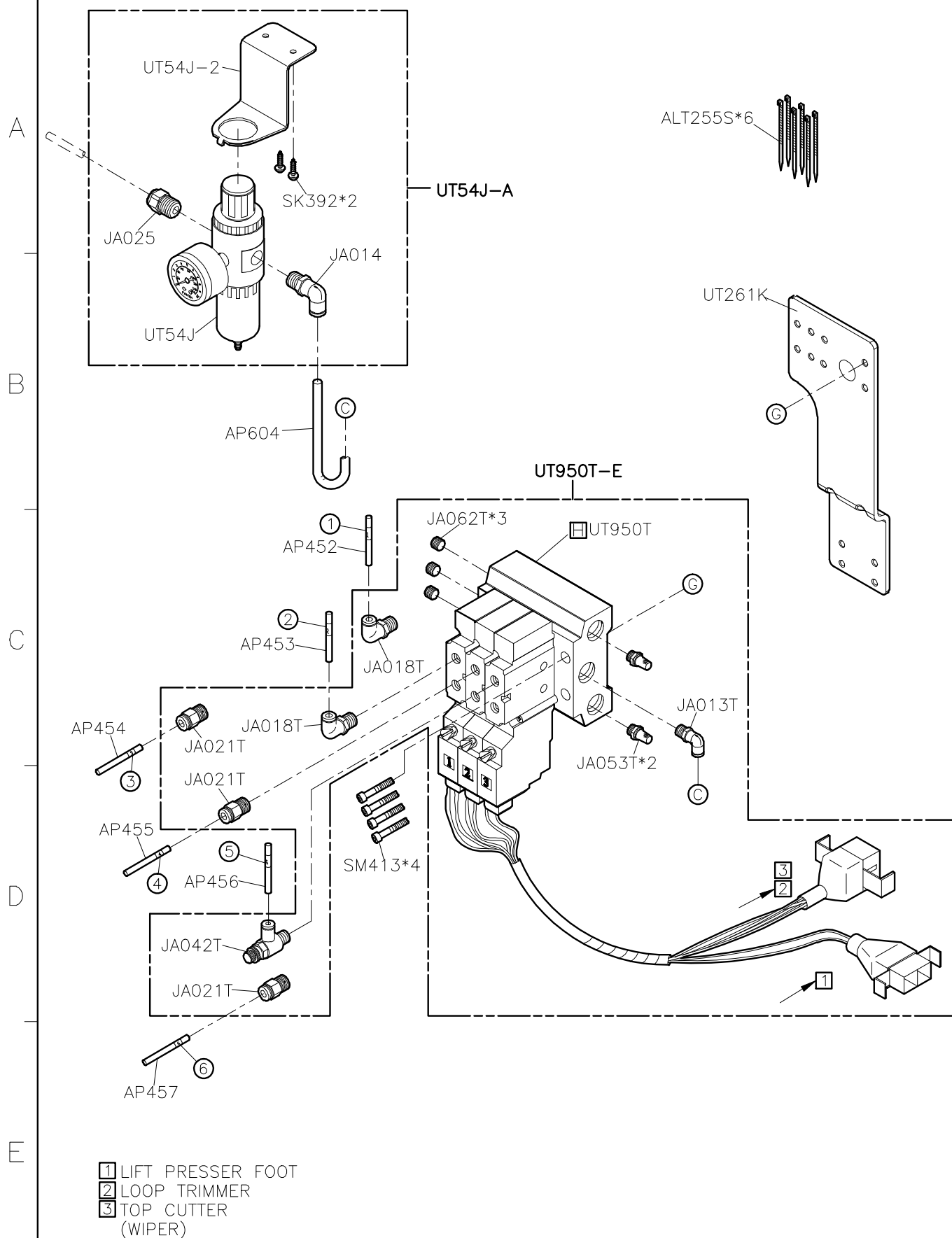

SIRUBA PARTS LIST	Series	Parts Group	Subclass / Remark	Page
	S007K/S007KD U007	UTT(UTU)-K	For S007K/S007KD 2nd Generation	4/9
				Date
				2016/8/24

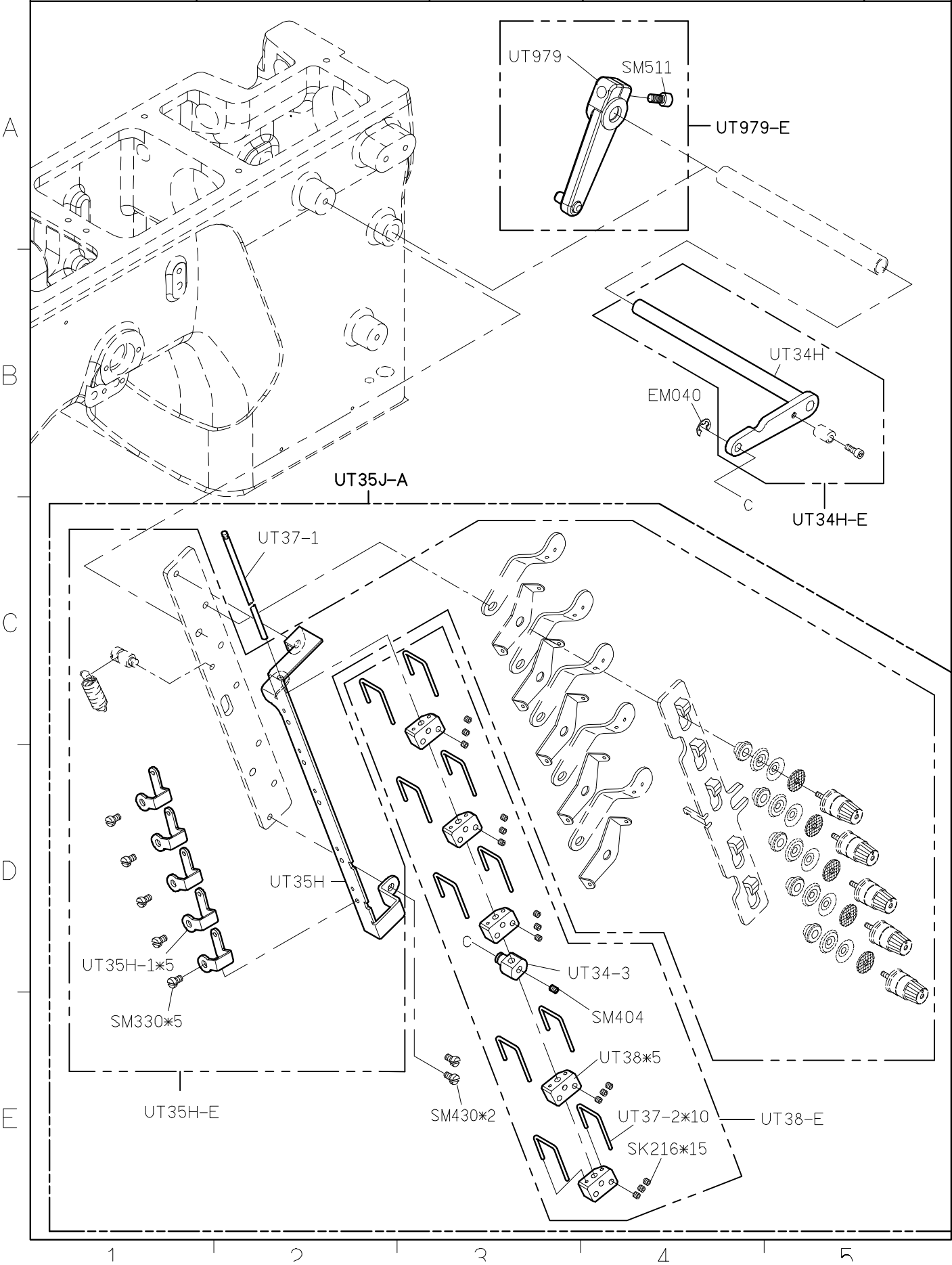

SIRUBA PARTS LIST	Series	Parts Group	Subclass / Remark	Page
	S007K/S007KD U007	UTU-K	For S007K/S007KD 2 nd Generation	5/9
				Date
				2022/09/27

FOR LEFT SIDE

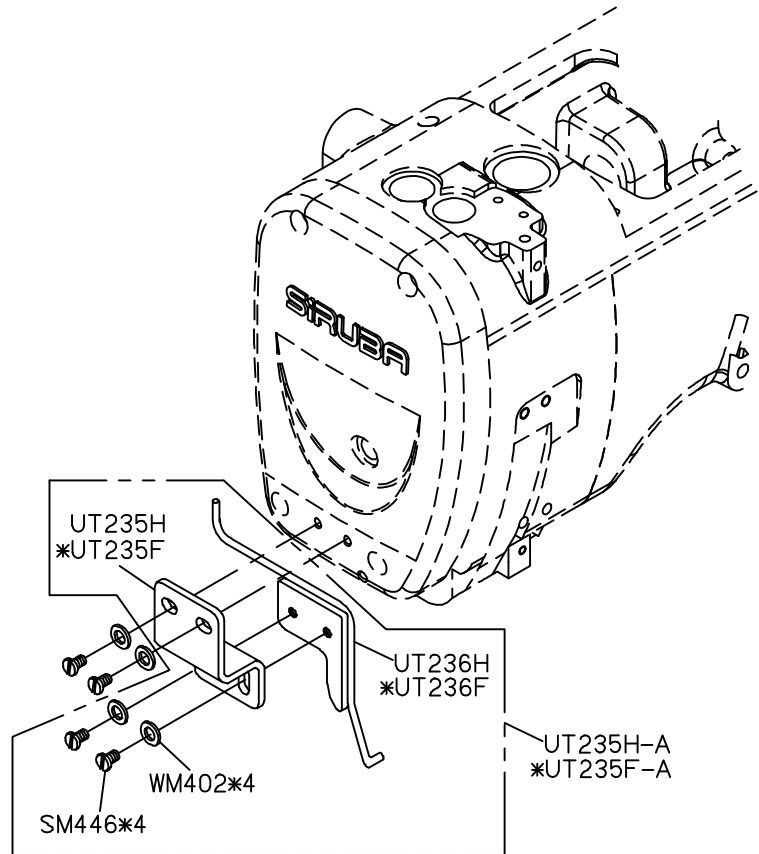

SIRUBA PARTS LIST	Series	Parts Group	Subclass / Remark	Page
	S007K/S007KD U007	UTU-K1	For allocation	6/9
				Date
				2020/4/17

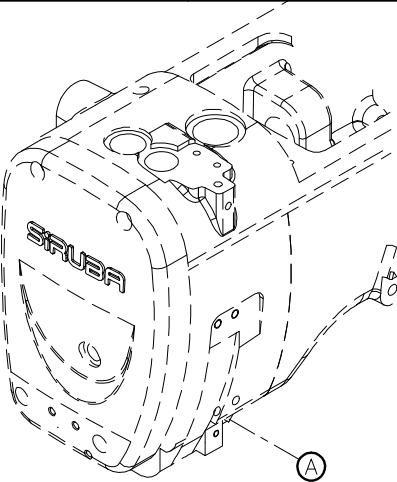

WP51L-A1

AC027-E

AC027

WP51L-A

SM418*2

WP55

WP51L

WP42

WP41K

SM130

WM811

NM816

NM410*2

NM410

WM440

WP52

SM4553B*2

SM4306

WP56

SM410*2

WM402*2

WM402*2

SM410*2

SM330

WM301

SM030

WM310

UT564

WP58

WP34K

WP53

SM4831

WP32

BC715

WP36

1

2

3

4

5

SIRUBA PARTS LIST	Series	Parts Group	Subclass / Remark	Page
	S007K/S007KD U007	UTT-K	For S007K/S007KD 2 nd Generation	7/9
				Date
				2020/3/12

A

B

C

D

E

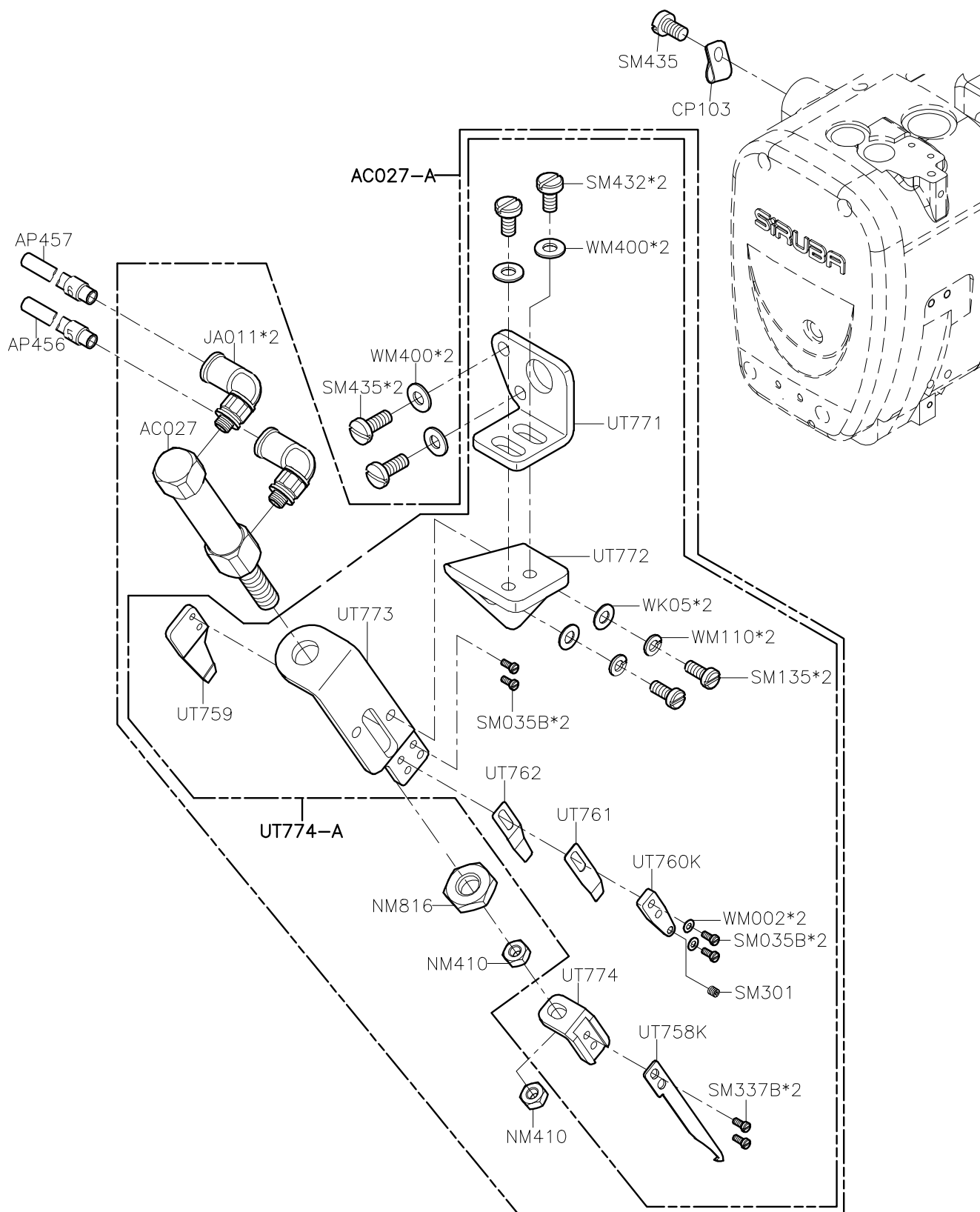

1

2

3

4

5

SIRUBA PARTS LIST	Series	Parts Group	Subclass / Remark	Page
	S007K/S007KD U007	UTT(UTU)-K	For S007K/S007KD 2 nd Generation ☐ : Use for H brand motor	8/9
				Date
				2016/9/14

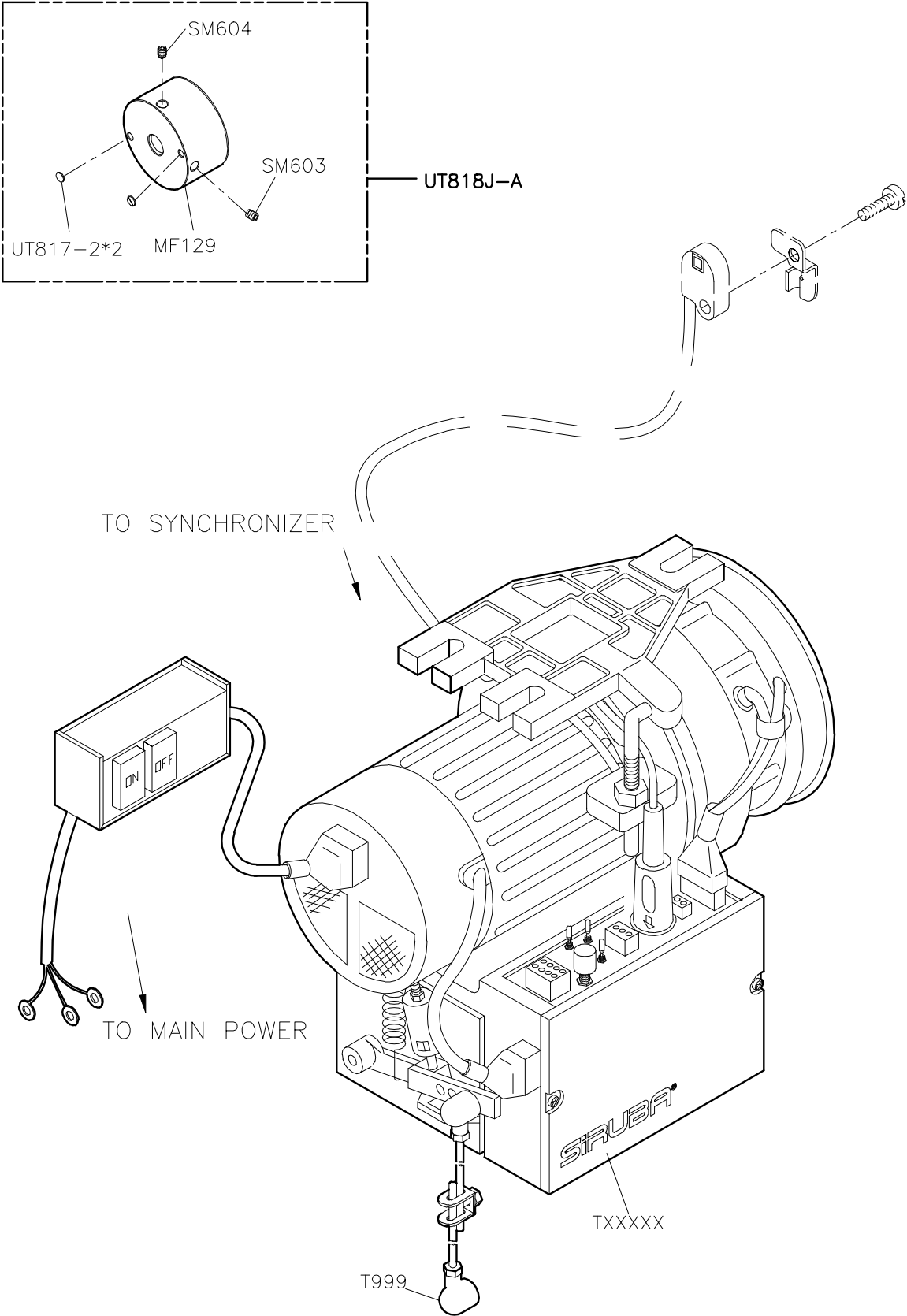

SIRUBA PARTS LIST	Series	Parts Group	Subclass / Remark	Page
	S007K/S007KD U007	UTT(UTU)-K	For S007K/S007KD 2 nd Generation ☐ : Use for H brand motor (i - 60)	9/9
				Date
				2016/8/24

A

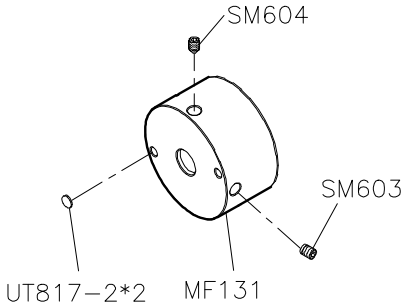

B

C

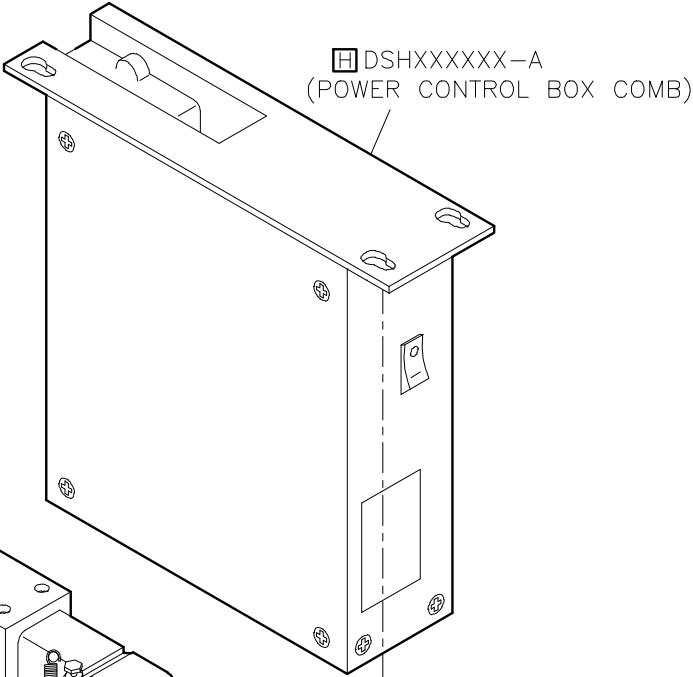

D

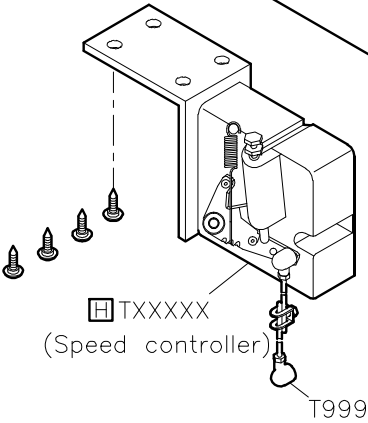

E

SIRUBA

PARTS LIST

Series

U007

Parts Group

UTX(UTY)-K

Subclass / Remark

Page

1/9

Date

2020/7/15

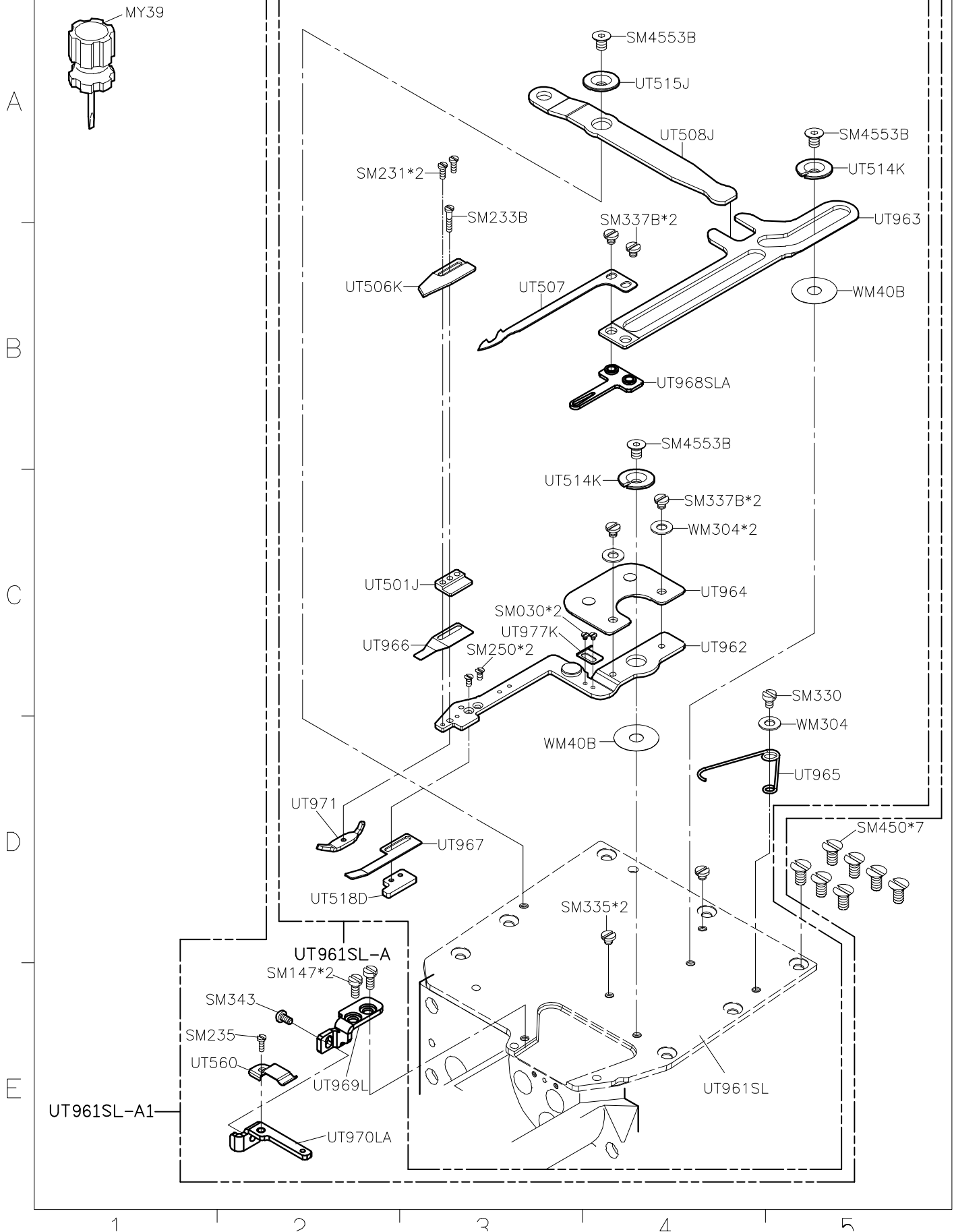

SIRUBA
PARTS LIST

Series
**S007K/S007KD
U007**

Parts Group
UTX(UTY)-K

Subclass / Remark
For S007K/S007KD 2nd Generation
☐ : Use for H brand motor

Page
2/9
Date
2016/8/23

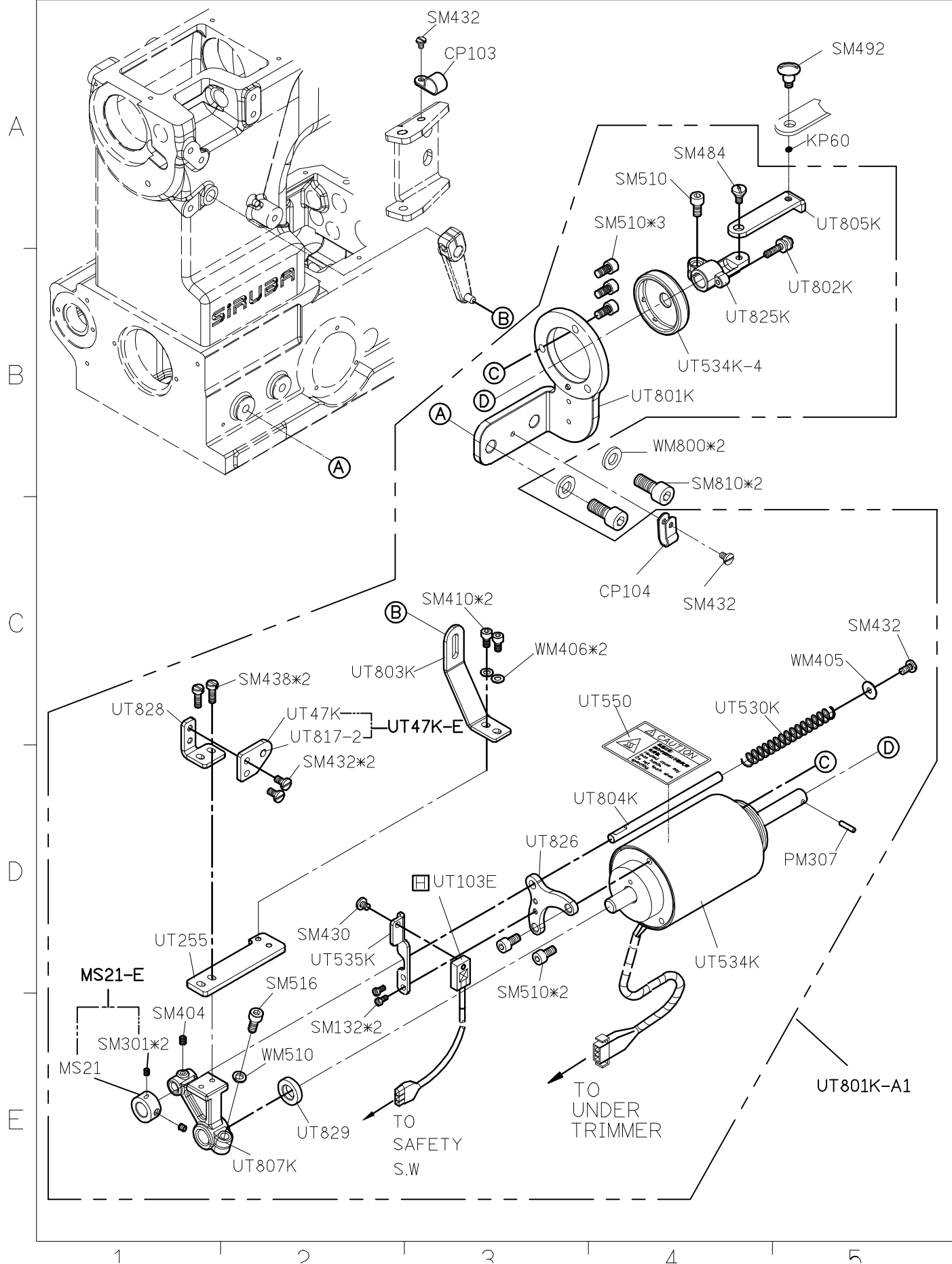

SIRUBA PARTS LIST	Series	Parts Group	Subclass / Remark	Page
	S007K/S007KD U007	UTX(UTY)-K	For S007K/S007KD 2nd Generation	3/9
				Date
				2020/4/17

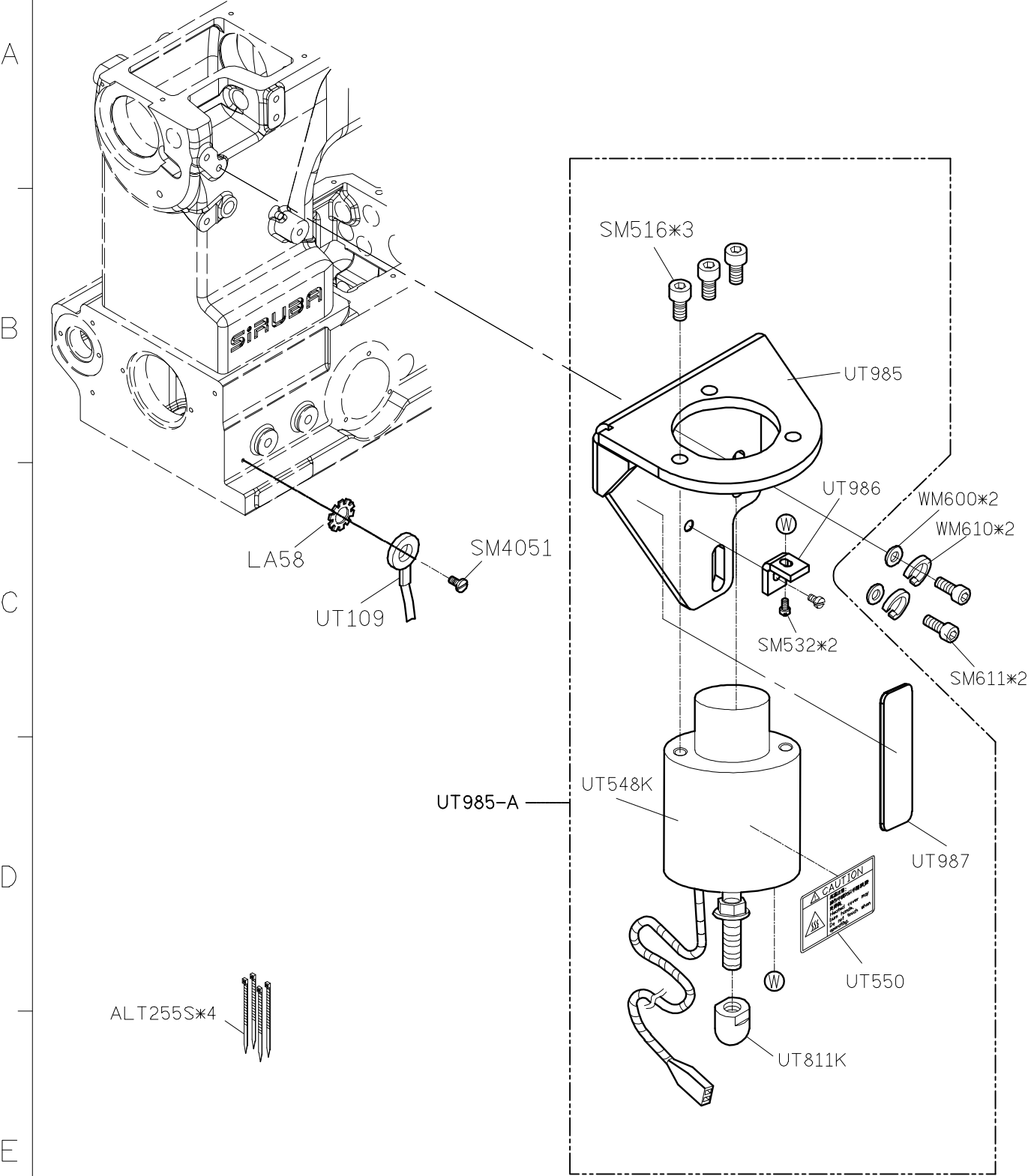

SIRUBA PARTS LIST	Series	Parts Group	Subclass / Remark	Page
	S007K/S007KD U007	UTX(UTY)-K	For S007K/S007KD 2nd Generation	4/9
				Date
				2016/8/23

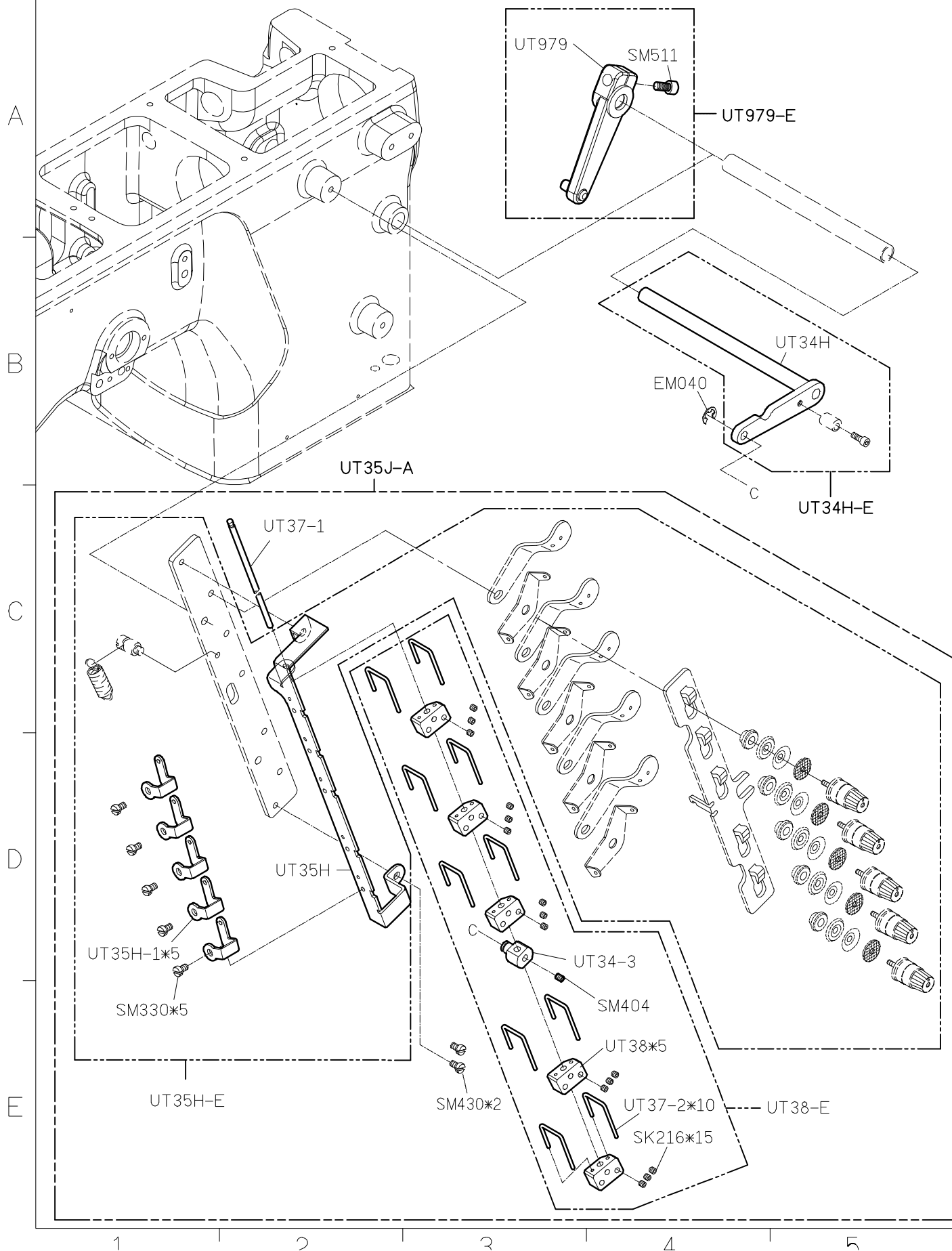

SIRUBA PARTS LIST	Series	Parts Group	Subclass / Remark	Page
	S007K/S007KD U007	UTX-K	For S007K/S007KD 2 nd Generation	5/9
				Date
				2020/03/12

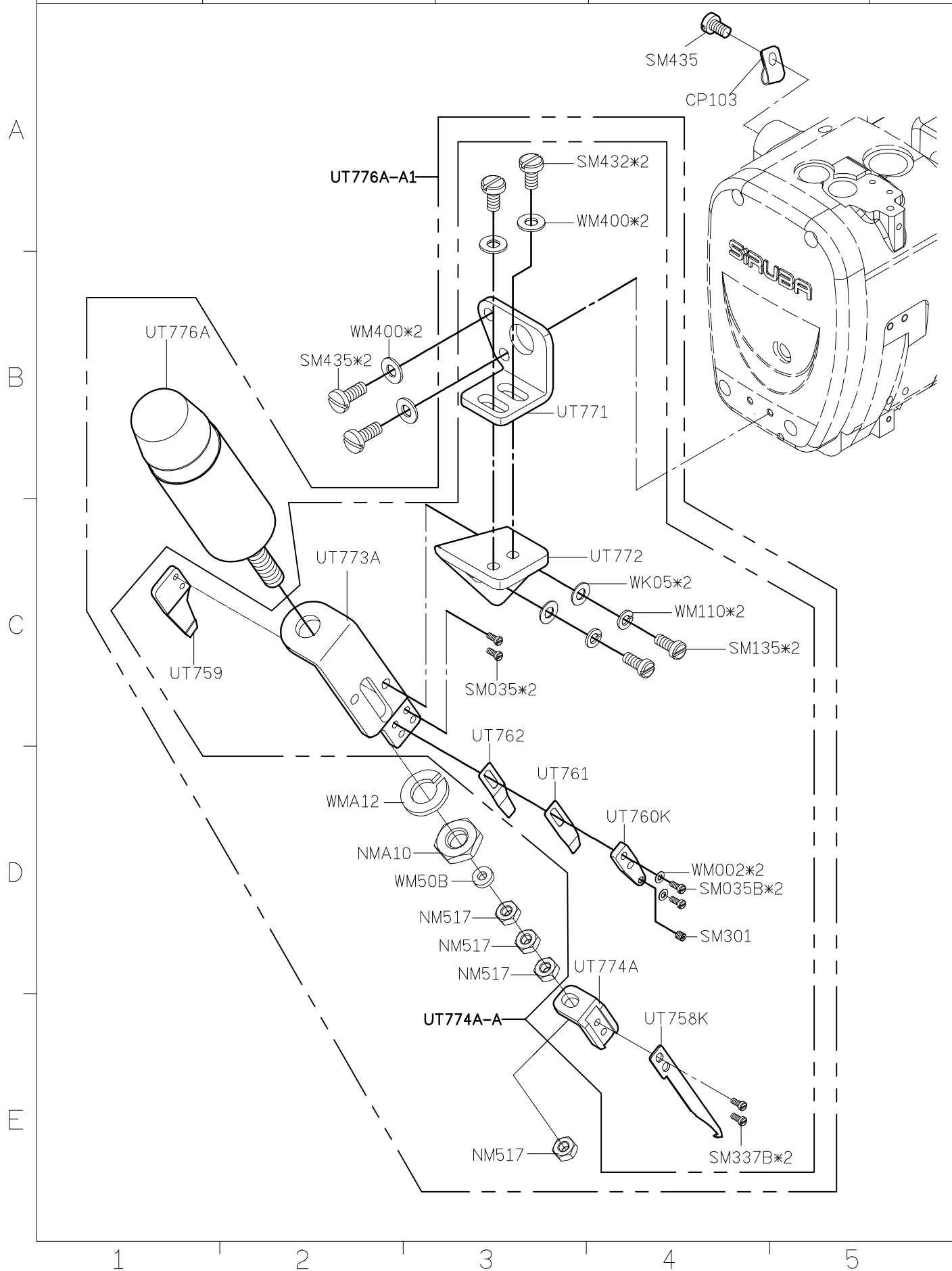

SIRUBA PARTS LIST	Series	Parts Group	Subclass / Remark	Page
	S007K/S007KD U007	UTY-K	For S007K/S007KD 2 nd Generation	6/9
				Date
				2020/4/17

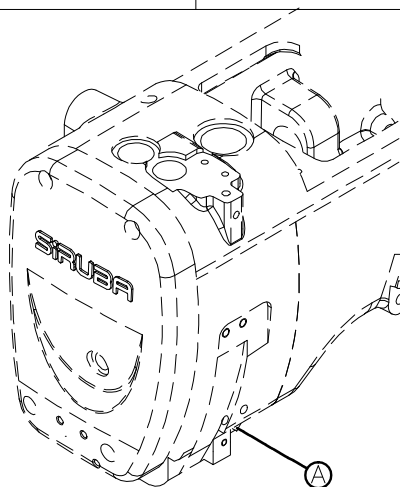

WP54A-A1

UT776A

WP54A-A

SM418*2

WP55A

WP51L

WMA11
NMA10

WM50B
NM517

NM410

NM410

WM440

WP52

WP42

WP41K
SM130

SM410*2

WP56

WM402*2

SM330
WM301

NM410

WM440

SM4553B*2

SM4306

WP32

WP34K

WP53
SM4831

WP36

BC715

WM402*2

SM410*2

UT564
WP58

WM510
NM517

1

2

3

4

5

SIRUBA PARTS LIST	Series	Parts Group	Subclass / Remark	Page
	S007K/S007KD U007	UTX(UTY)-K	For S007K/S007KD 2 nd Generation □ : Use for H brand motor	7/9
				Date
				2016/8/23

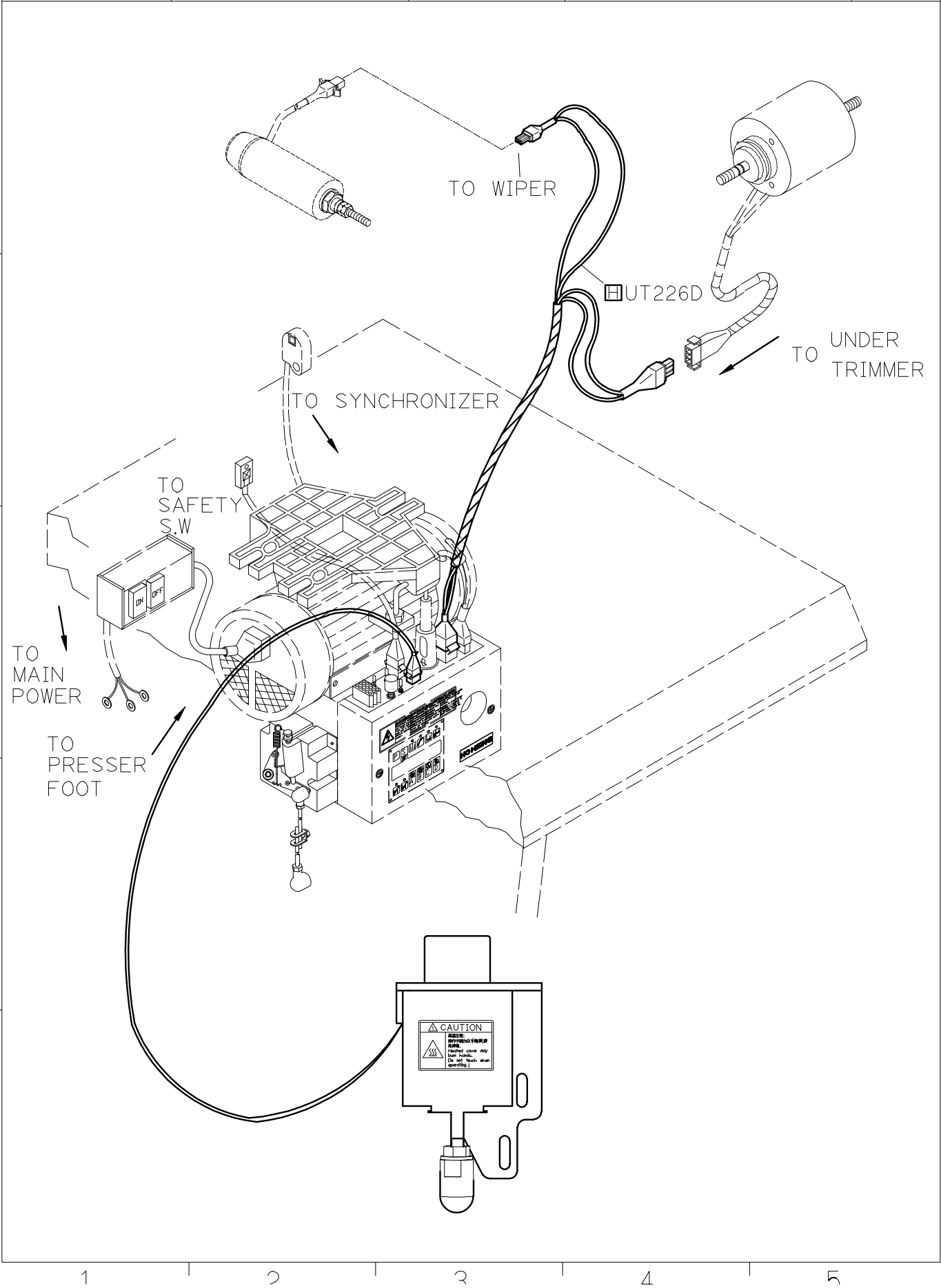

SIRUBA PARTS LIST	Series	Parts Group	Subclass / Remark	Page
	S007K/S007KD U007	UTX(UTY)-K	For S007K/S007KD 2 nd Generation ☐ : Use for H brand motor	8/9
				Date
				2016/8/23

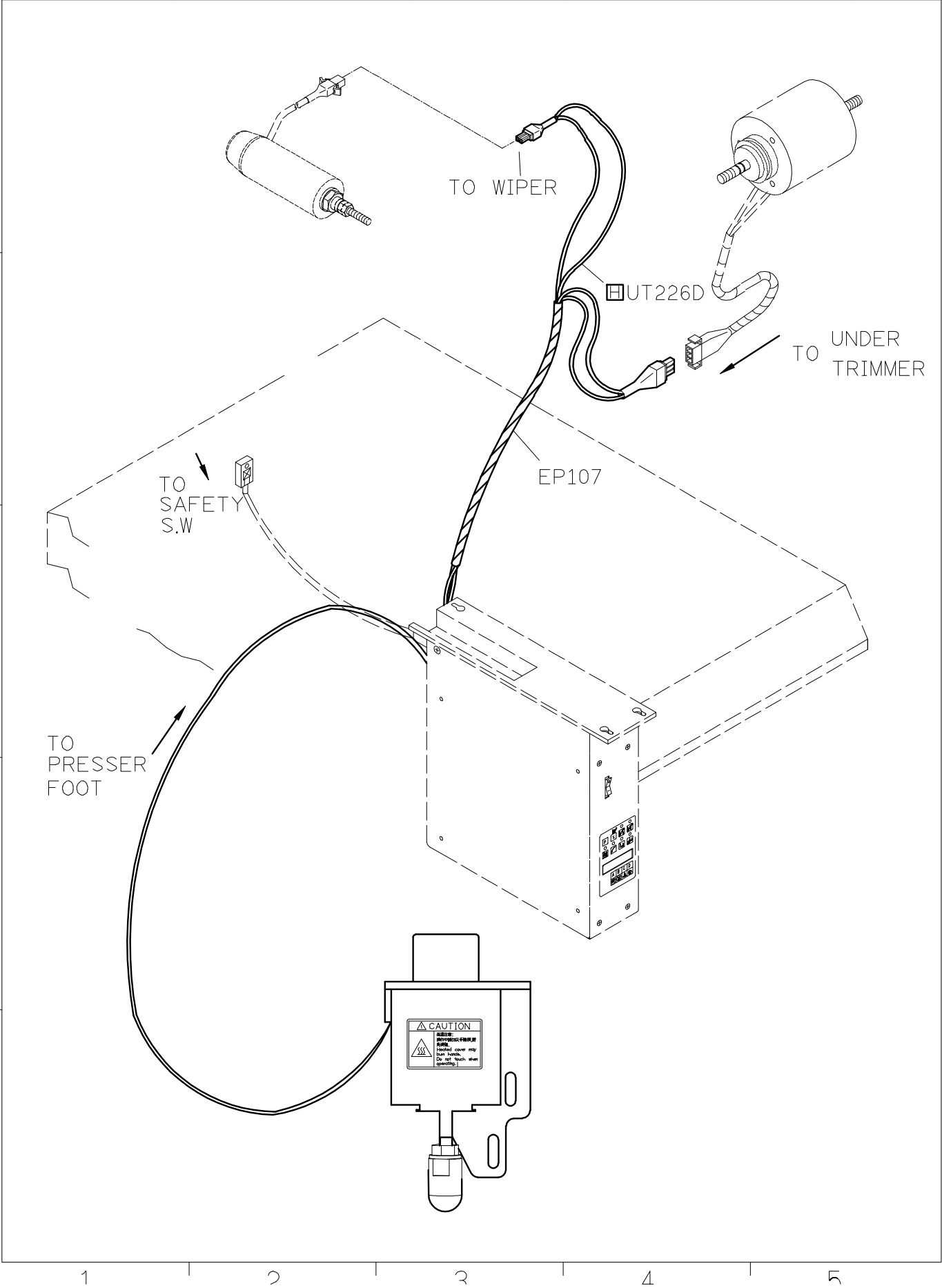

<div> <div>SIRUBA</div> <div>PARTS LIST</div> </div>	Series	Parts Group	Subclass / Remark	Page
	<div> <div>S007K/S007KD</div> <div>U007</div> </div>	<div>UTX(UTY)-K</div>	<div> <div>For S007K/S007KD 2nd Generation</div> <div> <div>☐</div> <div>: Use for H brand motor</div> <div>(1-60)</div> </div> </div>	9/9
				Date
				2016/8/23

