

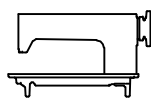





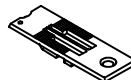
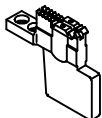

SIRUBA GAGE PARTS LIST		Series		Remark				Page	Date
		DT828						1 / 1	2022/01/26
									
MODEL	SUB-CLASS	NEEDLE PLATE	FEED DOG	NEEDLE CLAMP	PRESSER FOOT	HOOK	BOBBIN	NEEDLE	
機 型	規 格	針 板	下送具	針 鉗	押 具	旋 梭	梭 子	針 號	
DT828-42-048M	3/16"(4.8)	E736	D736/P	M736	P736/S	G162-A (G162+G406)	G307	DPX5#14	
DT828-42-048ML	3/16"(4.8)	E736	D736/P	M736	P736/S	G161	G307	DPX5#14	
DT828-42-064H	1/4"(6.4)	E760	D730Q	M730	P730/S	G162-A (G162+G406)	G307	DPX5#22	
DT828-42-064HL	1/4"(6.4)	E760	D730Q	M730	P730/S	G167	G307	DPX5#22	
DT828-42-064M	1/4"(6.4)	E730	D730/P	M730	P730/S	G162-A (G162+G406)	G307	DPX5#14	
DT828-42-064ML	1/4"(6.4)	E730	D730/P	M730	P730/S	G161	G307	DPX5#14	
DT828-45-064H	1/4"(6.4)	E760	D730Q	M0064R M0064L	P730/S	G169-A (G169+G409)	G307	DPX5#22	
DT828-45-064M	1/4"(6.4)	E760	D730/P	M0064R M0064L	P730/S	G169-A (G169+G409)	G307	DPX5#14	
DT828-72-064HL	1/4"(6.4)	E760	D730Q	M730	P760/S	G165	G310	DPX5#22	
DT828-72-064M	1/4"(6.4)	E760	D730	M730	P760/S	G165	G310	DPX5#14	
DT828-72-064ML	1/4"(6.4)	E760	D730/P	M730	P760/S	G165	G310	DPX5#14	
DT828-75-064H	1/4"(6.4)	E760	D730Q	M0064R M0064L	P760/S	G166-A (G166+G407)	G310	DPX5#22	
DT828-75-064M	1/4"(6.4)	E760	D730/P	M0064R M0064L	P760/S	(G166+G407)	G310	DPX5#14	

**SIRUBA**

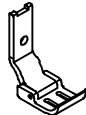
**PARTS LIST**

**Series**

**DT828<sup>-42</sup><sub>-72</sub>**

**Parts Group**

**TA**

**Subclass / Remark**

**With Direct-Drive Motor**

**Page**

**1/4**

**Date**

**2022/01/25**

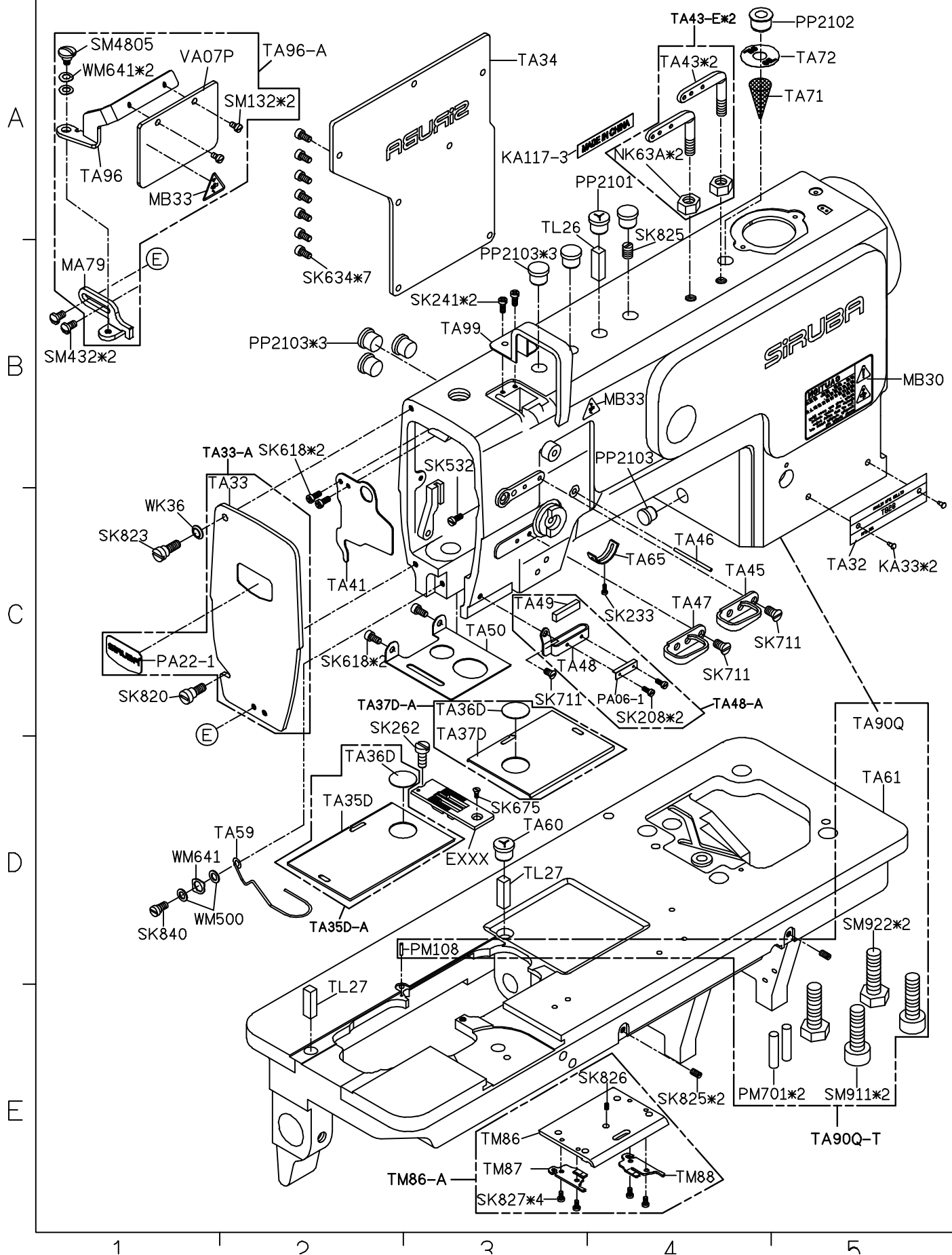



<b>SIRUBA</b>  <b>PARTS LIST</b>	Series	Parts Group	Subclass / Remark	Page
	DT828	TA		3/4
				Date
				2022/01/25

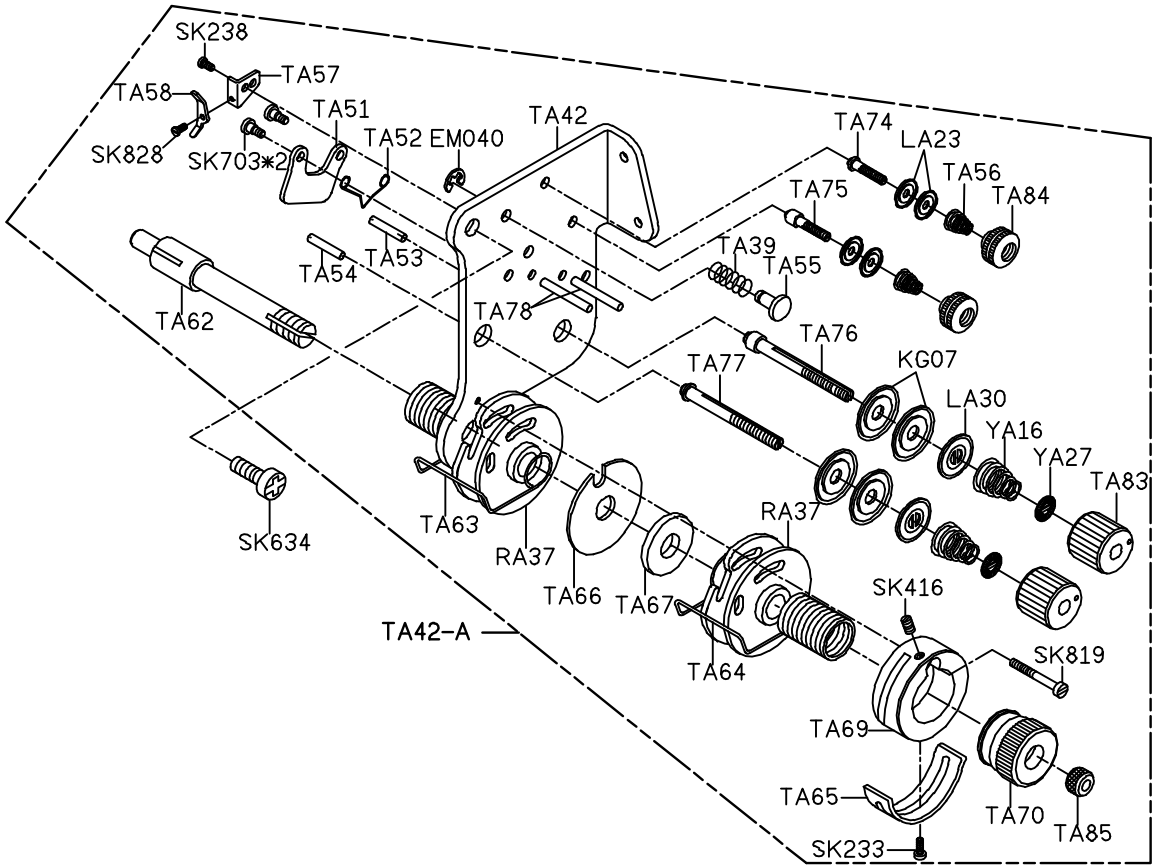

<b>SIRUBA</b>  <b>PARTS LIST</b>	Series	Parts Group	Subclass / Remark	Page
	<b>DT828</b>	<b>TA</b>	With Direct-Drive Motor	4/4
				Date
				2022/07/22

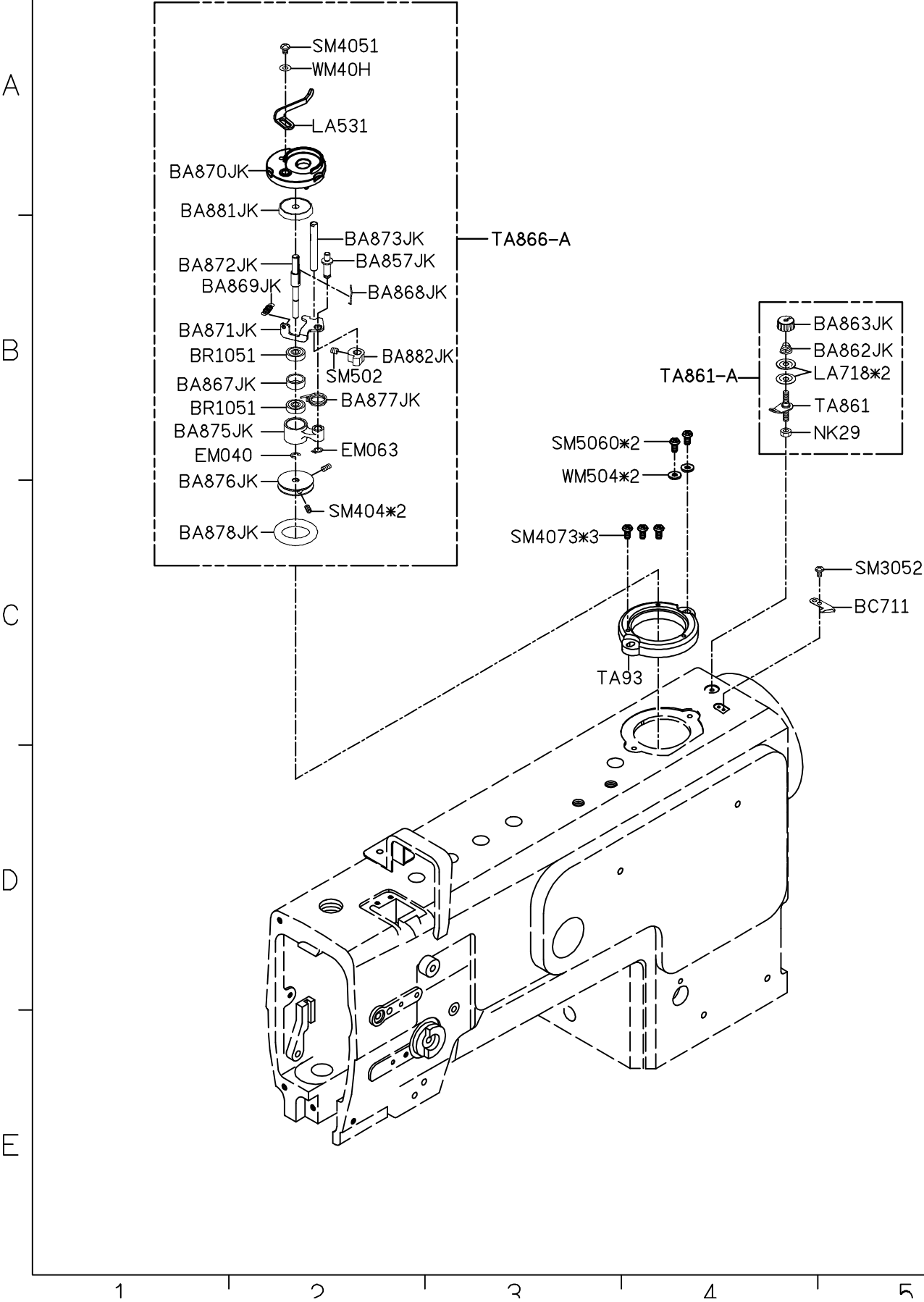



SIRUBA PARTS LIST		Series		Parts Group	Subclass / Remark	Page			
		DT828 <sup>-45</sup> -75				2/3			
						Date			
						2022/01/25			
MODEL	DT828-45		DT828-75		★在訂單前，請先確認另件上的記號	TB72		TB77	
PARTS NO.	M	H	M	H		編號	MARK	編號	MARK
	TB26	TB26	TB26	TB26		TB72-25	25	TB77-B1	B1
	TB27-A	TB27-A	TB27-A	TB27-A		TB72-30	30	TB77-B2	B2
	TB90	TB90	TB97	TB97	TB72-35	35	TB77-B3	B3	
					TB72-40	40			
					TB72-45	45			
					TB72-50	50			
					TB72-55	55			
					TB72-60	60			
					TB72-65	65			
					TB72-70	70			
					TB72-75	75			
					TB72-80	80			

1

2

3

4

5

**SIRUBA**

**PARTS LIST**

**Series**

**DT828**

**Parts Group**

**TB**

**Subclass / Remark**

**With Direct-Drive Motor**

**Page**

**3/3**

**Date**

**2022/01/25**

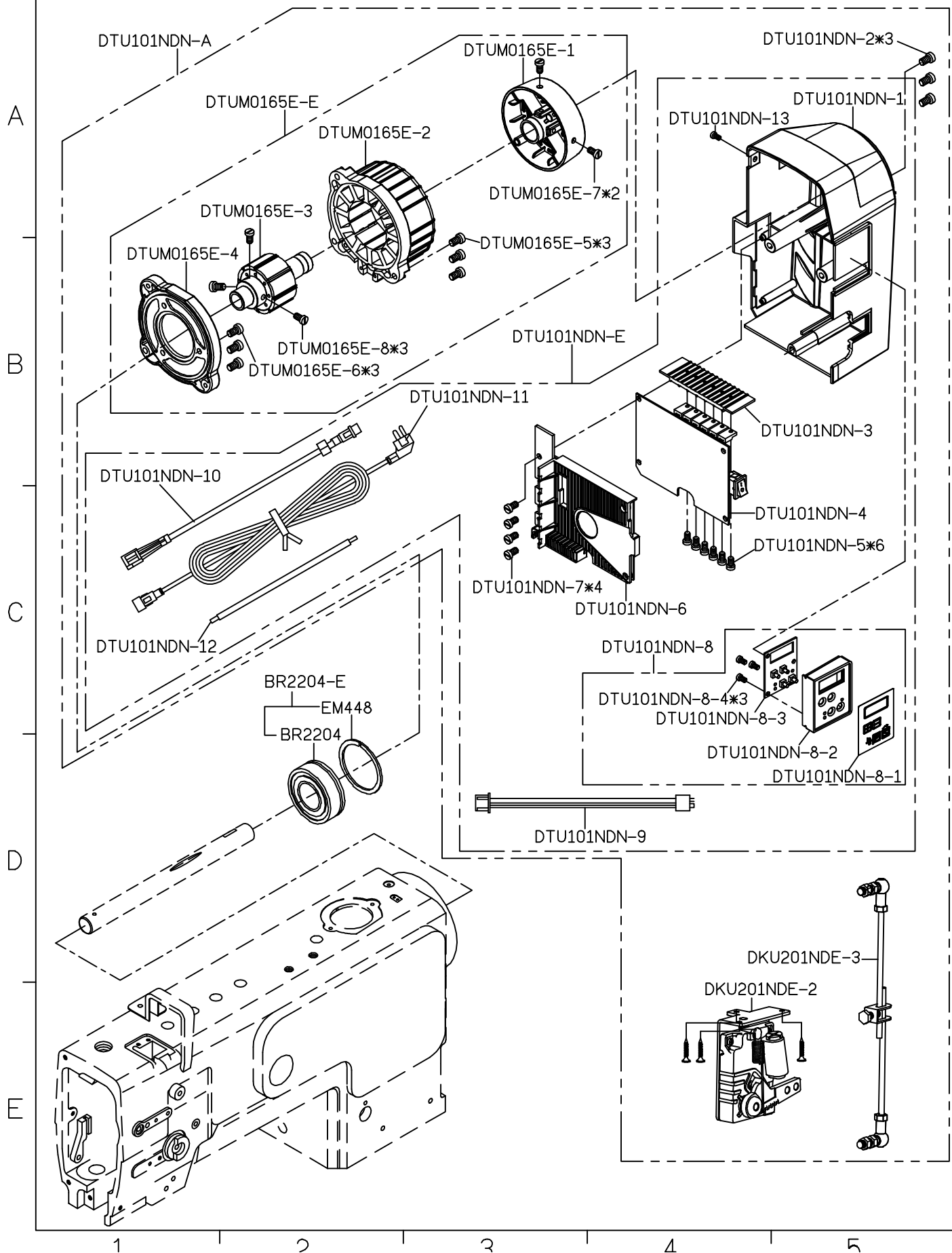



MODEL	DT828-42		DT828-45		DT828-72		DT828-75	
	M	H	M	H	M	H	M	H
PARTS NO	TC50	TC50	TC50	TC50	TC79	TC79	TC79	TC79
	TC66	TC81	TC66	TC81	TC82	TC82	TC82	TC82
	TC69	TC69	TC69	TC69	TC78	TC78	TC78	TC78
	TC70	TC85	TC70	TC85	TC70	TC70	TC70	TC70

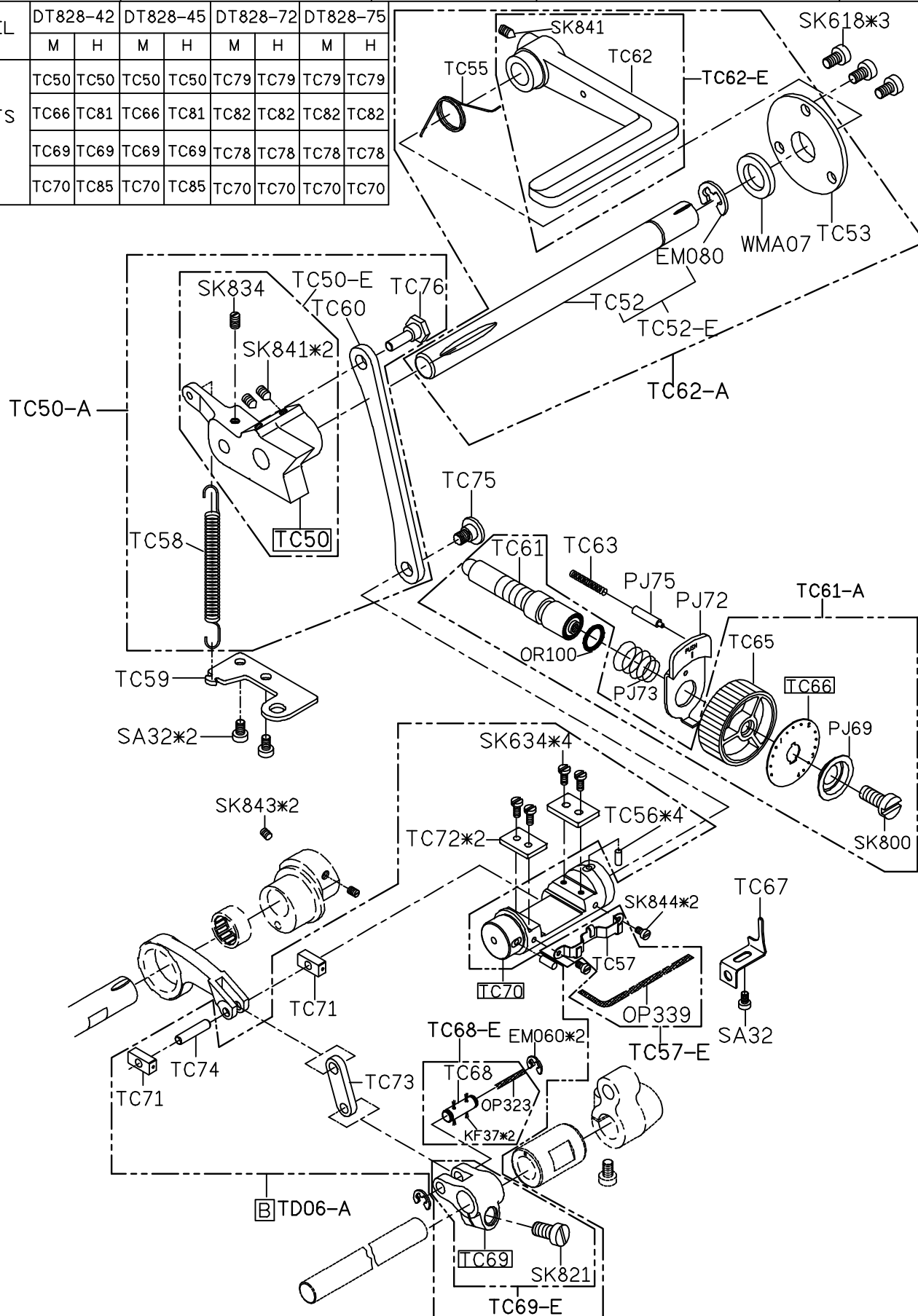

1

2

2

 $\Delta$ 

5

**SIRUBA**  
**PARTS LIST**

**Series**  
**DT828**

**Parts Group**  
**TD**

**Subclass / Remark**

**Page**  
1/1  
**Date**  
2022/01/25

MODEL	DT828-42/45		DT828-72/75	
	M	H	M	H
PARTS NO	TD01	TD01	TD30	TD30
	TD02	TD02	TD31	TD31
	TD03	TD03	TD03	TD03
	TD04	TD04	TD28	TD28
	TD19	TD19	TD29	TD29

**A** + **B** = TD06-A  
TD TC  
系列 系列

**SIRUBA**

**PARTS LIST**

**Series**

**DT828**

**Parts Group**

**TE**

**Subclass / Remark**

**Page**

**1/1**

**Date**

**2022/01/28**

MODEL	DT828-42/45		DT828-72/75	
	M	H	M	H
PARTS NO	TE06	TE06	TE56	TE56
	TE07	TE07	TE57	TE57
	TE15	TE15	TE58	TE58
	TE18	TE18	TE59	TE59
	TE52	TE52	TE62	TE62
	TE53	TE53	TE63	TE63

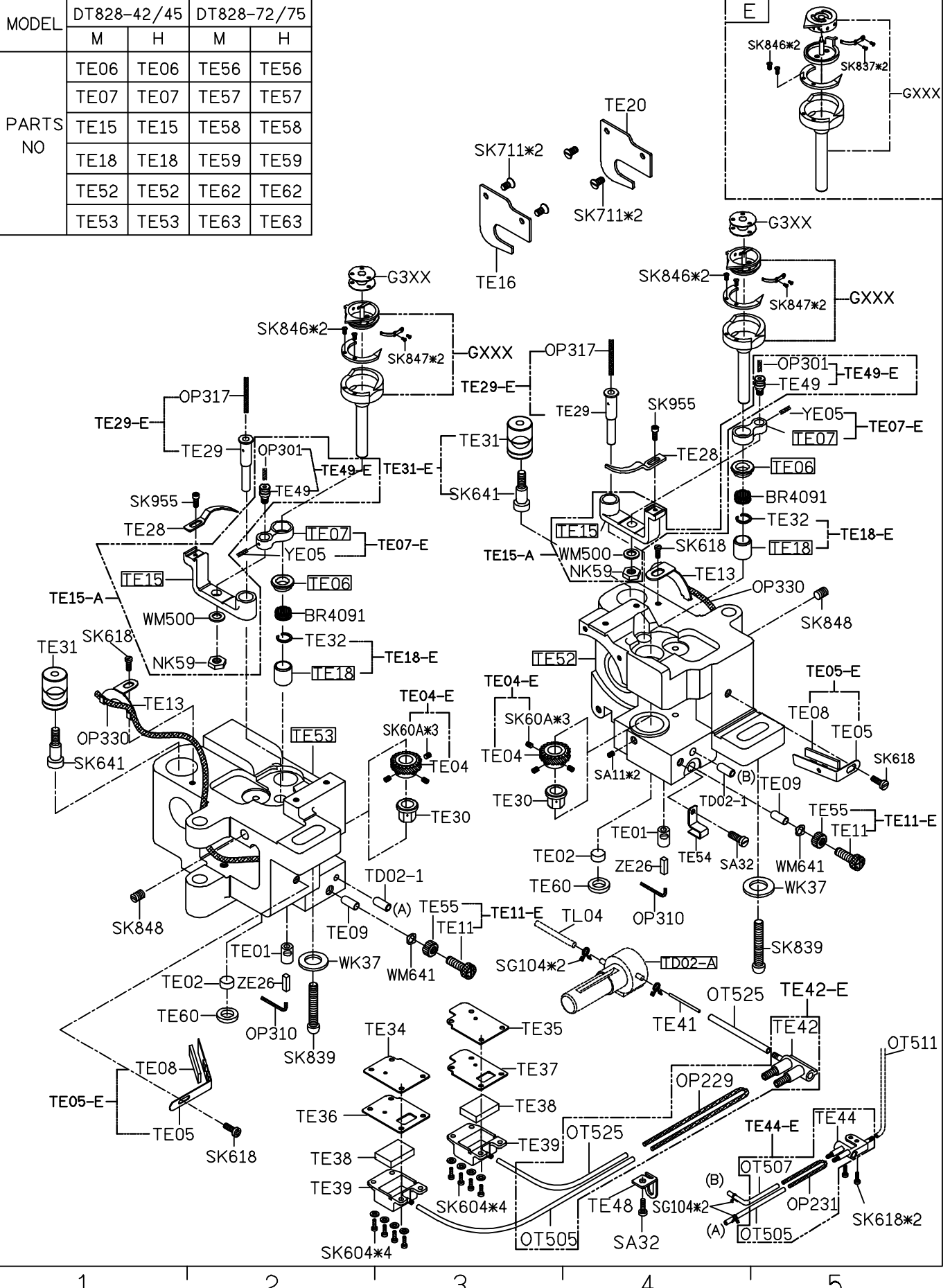

SIRUBA PARTS LIST	Series		Parts Group		Subclass / Remark		Page
	DT828		TI				1/1
							Date
							2022/01/28

MODEL	DT828-42/45		DT828-72/75	
	M	H	M	H
PARTS NO	TI07	TI07	TI07	TI07

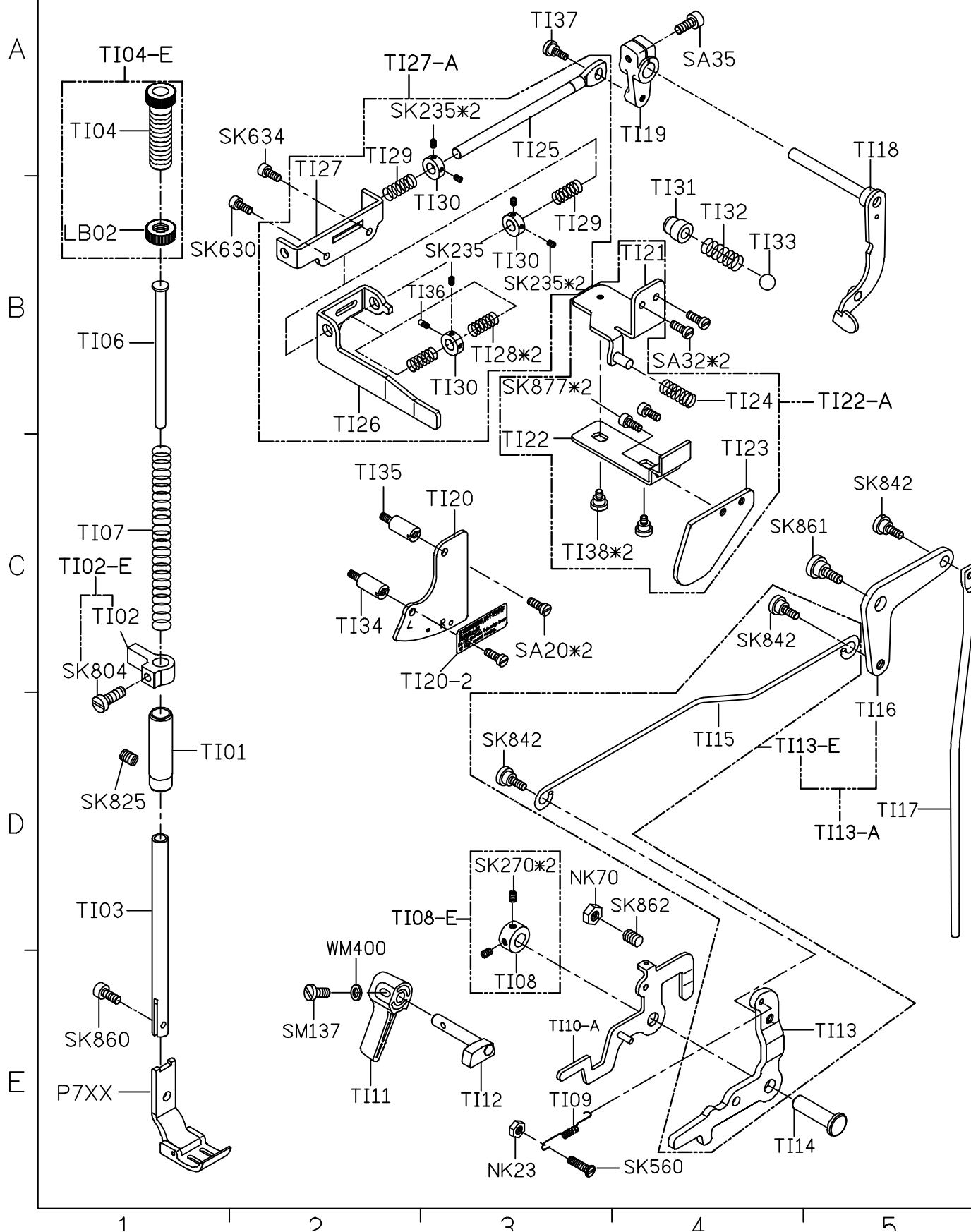



<b>SIRUBA</b> PARTS LIST	Series	Parts Group	Subclass / Remark	Page
	DT828	TN	△: 高銀生産用	1/1
				Date
				2022/02/16

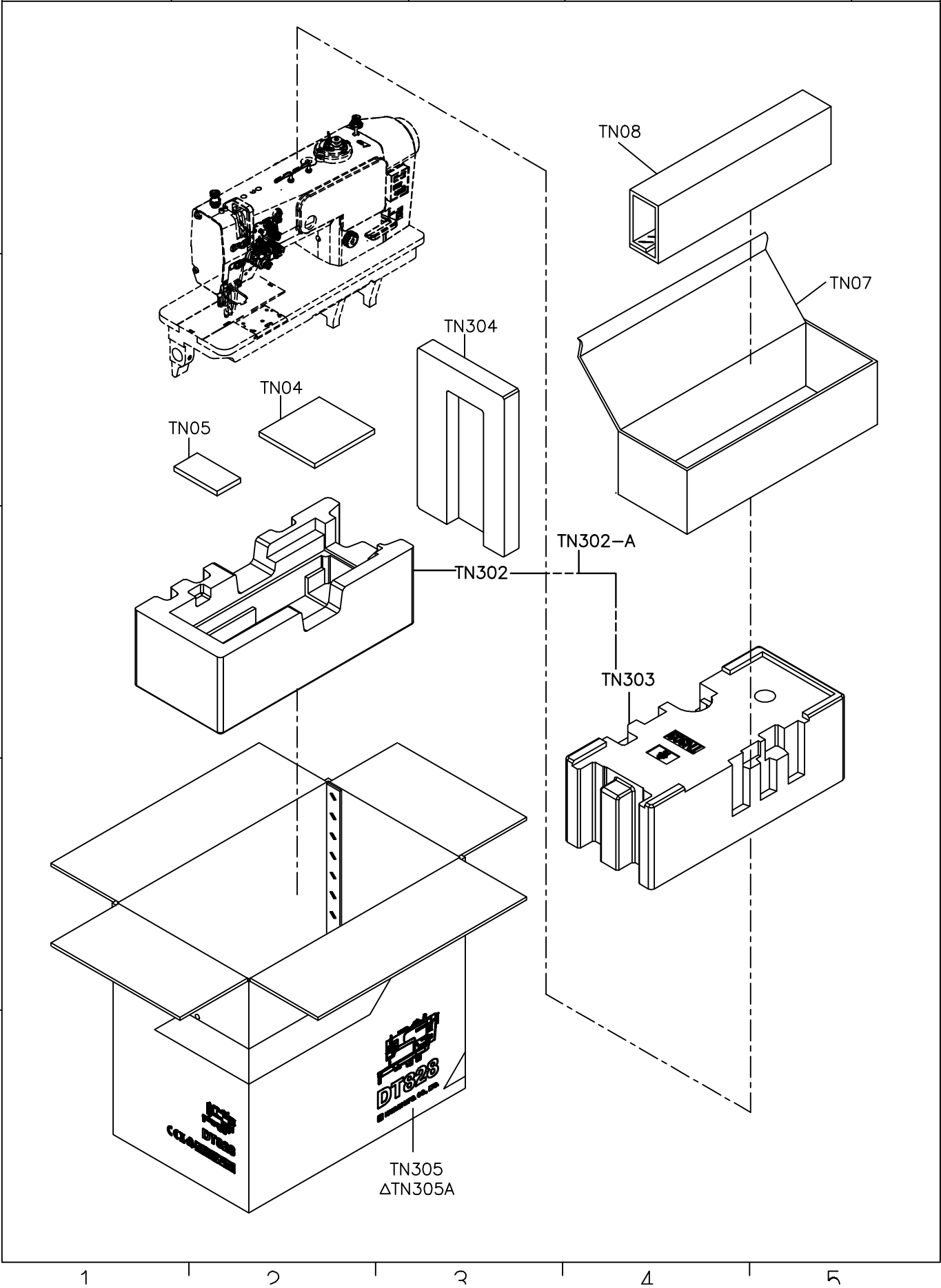

<b>SIRUBA</b>  <b>PARTS LIST</b>	Series	Parts Group	Subclass / Remark	Page
	DT828	TY		1/2
				Date
				2012/09/08

A

B

C

D

E

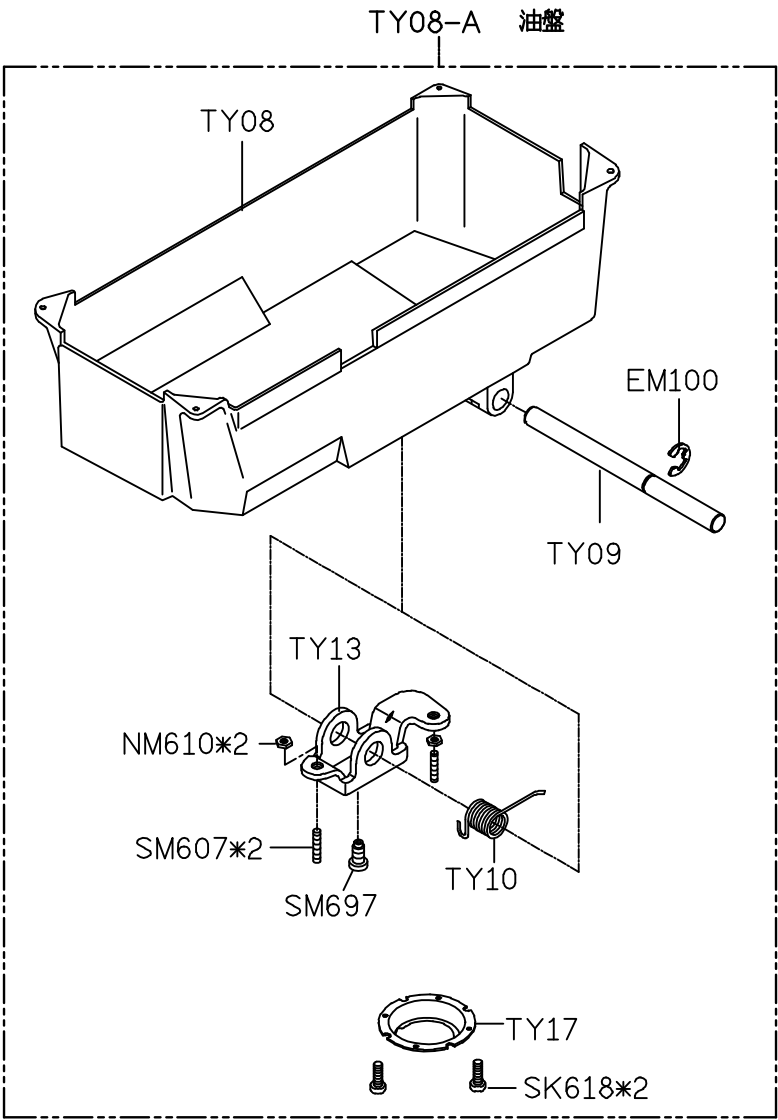

SIRUBA PARTS LIST	Series	Parts Group	Subclass / Remark	Page
	DT828	TY		2/2
				Date
				2022/01/26

A	14 押具提昇軸 	15*4 防震橡膠墊 	16 油 壺 	MY01 防塵罩 	KZ03 乾燥劑 
	PY05*4 鐵 釘 	GXXX*4 梭 子 	KY02F-T 油 罐 	KY03 油 壺 	LY04*2 後鈕墊 
	LY05*2 後 鈕 	LY33 一字起子 	LY02 木頭桿 	KY201 工具袋 	針*4 

C

D

E

MODEL	DT828-42		DT828-45		DT828-72		DT828-75	
	M	H	M	H	M	H	M	H
PARTS NO	G307	G307	G307	G307	G310	G310	G310	G310
	—	—	KY14	KY14	—	—	KY14	KY14
	DPX5#14	DPX5#22	DPX5#14	DPX5#22	DPX5#14	DPX5#22	DPX5#14	DPX5#22

1

2

3

4

5



<div> <div>SIRUBA</div> <div>PARTS LIST</div> </div>	Series	Parts Group	Subclass / Remark	Page
	DT828	KW		1/1
				Date
				2022/01/26

PY11-3

A

B

C

D

E

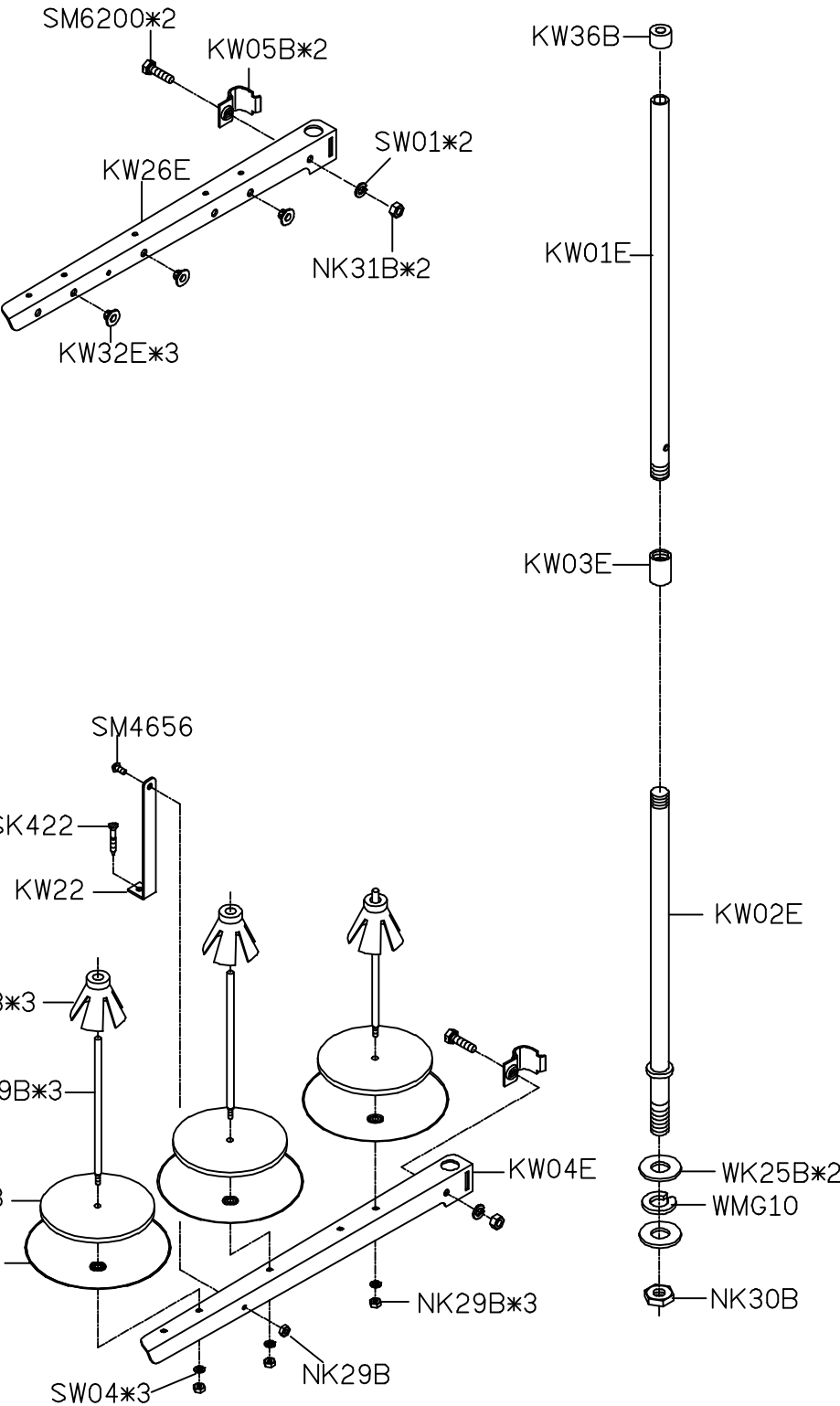

1

2

3

4

5

