

DL7500SX

Semi-Dry Computerized Lockstitch Machine with
Three Stepping Motor and Touch Panel

三步进电脑触控微油平缝车

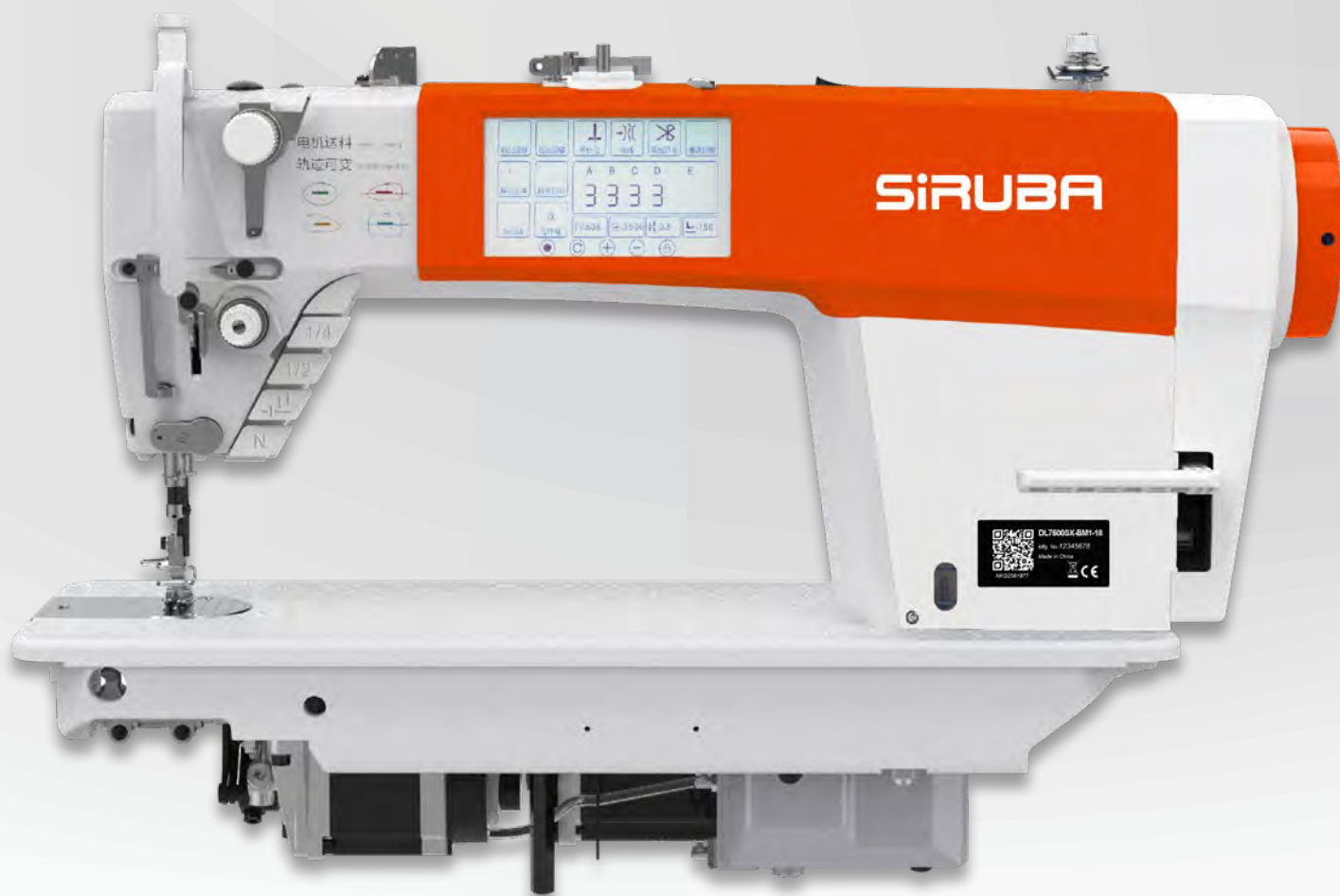

本机采用一体式智能操作系统，配备5寸触摸显示屏，简化操作逻辑，参数调整更加便捷。无轴承主轴伺服马达、花样米粒缝、包油盘、电子膝控、短线头等功能，且送布、剪线、抬压脚为步进电机驱动，稳定低噪音，功能齐全，质量稳定。

This machine adopts an integrated intelligent operating system, equipped with a 5-inch touch screen, which simplifies the operation logic and makes parameter adjustment more convenient. Special features include bearing-less spindle servo motor, pattern stitch, sealed oil tank, electronic knee pad, short thread trimmer. Feeding, thread trimming and presser foot lifting are driven by stepping motors, which is stable and quiet. Completed functions and stable quality.

特点

FEATURES

触控屏：
5英寸彩色
触摸屏，内
容直观，操
作方便。



Advanced touch screen:
5-inch colored touch screen,
intuitive and convenient.

四个按键：
配有四个功能键，方便进行倒
缝加固、补针（补1针，补1/2
针，1/4针）操作。



Four buttons:
Equipped with four functional buttons, so that it is
convenient for backstitch and stitch compensation
(1 stitch, 1/2 stitch, 1/4 stitch).



黑金钢针杆：
采用DLC涂层针
杆，减少了头部
供油，显著减少
针杆漏油。

DLC needle bar:
DLC coating helps to decrease the
oil supply and to prevent the needle
bar from oil leakage.

1 步进挑线杆机构：
此功能由步进马达分别驱动，曲柄、连杆、副挑线杆所组成。挑
线收线调整自如，实现起缝小鸟巢功能，适应不同针距和布料厚
度的缝制需求，线迹美观度大大提升！

Stepping motor drive tack-up thread lever:

Driven by stepping motors, it consists of a crank, connecting
shaft, and vice take-up thread lever. The picking thread can
be adjusted freely, achieving the function of sewing small
bird nests, adapting to the sewing needs of different needle
distances and fabric thicknesses, greatly improving the
aesthetic appearance of the stitches!

2 步进马达双向驱动技术(专利技术)：
一个马达完成切线和抬压脚动作。
Two-way stepping motor technology(patented):
One motor completes thread trimming and presser foot lifting.

3 短线头：
采用电机驱动的双动刀剪线机构，可在机针正下方完成剪线，缝
纫后的线头最短可达3mm，可有效减少人工剪线的工作量。
Short thread head:
The shortest thread head is down to 3mm, which can
effectively reduce workload of manual trimming.

4 机电控制狗齿送料：
4种送料轨迹，适应不同材质、厚、薄、有弹性、无弹性等面料。
①标准轨迹 ②薄、无弹性面料
③中厚、弹性面料④厚、无弹性面料
Digital Feed Dog Movement:
4 elliptical movements depending on the fabric you use,
choose between normal, smooth, soft or heavy fabric.
①Standard oval feed ②Thin, non-elastic fabric
③Medium-thick, elastic fabric ④Thick, non-elastic fabric

5 密封油盘设计：
避免油污造成的缝料污染，同时可减小整机运作时的噪音。
Oil tank design:
Sealed oil tank to avoid fabric from grease and to reduce
noise when machine operates.

6 厚薄通吃：
步进控制副撑线杆、狗齿轨迹、层缝模式，达到真正且稳定的
厚薄料车缝。
Versatility in thickness:
To achieve true and stable sewing for thick and thin fabrics
through stepping motor drive vice take-up thread level,
feed-dog movement, and layer-seam mode.

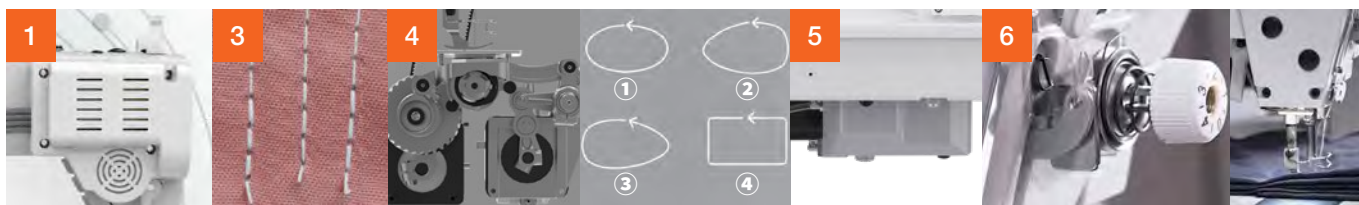

规格

SPECIFICATIONS

DL7500SX	Needle No.	布料厚度 Fabric Weight			mm			mm	S.P.M. (Max)	mm	KG
		L	M	H	手动 Hand	膝动 Knee	自动 Auto				
BM1-18	DB×1 #7 - #16				6	12	12	0~5	4500	L715 W305 H630	39.5 / 45.5

功能 Function	代码 Function Code	自动切线 Auto Trimming	倒缝 Reverse Feeding	电子夹线 Thread Gripper	自动抬压脚 Auto Lifter	防鸟巢 Bird Nest Prevention	可变线量 Adjustable Thread Pick-Up Level
	18	V	V	V	V	V	V

高林股份有限公司
KAULIN MFG. CO., LTD.

由於对产品的改良及更新，本产品型录中之产品规格及外观的修改恕不事先通知！
The specification and/or appearances of the equipment described in this catalogue
are subject to change without previous notice because of modification.

JUN. 2024